

a.k.a. casegoods
instructions

IMPORTANT NOTES

Failure to install product according to installation instruction will result in loss of warranty.

Tools required for assembly of workwalls:

- Tape measure
- 48" to 60" Level
- Cordless drill w/ driver & drill bits
- Rubber mallet
- Wood leveling shims
- Laser level



Suggested Fasteners for Workwall Structure connection to the wall:

Toggler® Snaptoggle® or similar high performance anchors — we suggest you use the 1/4"– 20 bolt version for added flexibility.

Workwall Installation



Step 1

Identify the highest point of the floor along the intended mounting wall. The highest point can be found by projecting a laser level on the wall and measuring the distance from the floor to the line. The smaller dimension is the highest point of the floor.



Step 2

Mark stud locations on the intended mounting wall. Additional anchoring to the studs is required during installation.



Step 3

The Workwall Structure must be installed starting at the highest point of the floor. Once the side to side location of the Workwall is determined, place the provided height spacer block in the corner at the predetermined highest point of the floor.

Standard Workwall configuration – 7 7/8" / 200mm above the high spot.

Electrical Workwall Configuration – 21 7/8" / 556mm above the high spot.



Step 4

Place the first Workwall Structure piece on the height spacer block.



Step 5

Using the vertical and horizontal laser guides, align the first Workwall Structure section. It is very critical that this first section is mounted level.



Step 6

Once the first section is leveled, temporarily attached the Workwall Structure section to the wall using drywall screws. This will temporarily keep the panel in position for marking the location of the wall anchors.



Step 7

Using a ¼" drill bit - drill through the pre-machined holes on the Workwall Structure into the drywall. This will locate the locations of the Snaptoggles®.

Note: you will also need to drill new holes through the Workwall Structure along the line where you have previously located the wall studs so that you can connect the panel to the studs with a #8 or #10 screw.



Step 8

Once all the holes have been drilled, remove the temporary drywall screws and set the first Workwall Structure section aside. Using a ½" drill bit, open up all the ¼" holes just drilled into the drywall to ½".



Step 9

Install 1 Toggler® Snaptoggle® wall anchor into each of the ½" holes.



Step 10

The first Workwall Structure section can now be attached to the wall using the ¼"-20 bolts into each of the Toggler® wall anchors. Be sure to re-level before securing the panel.

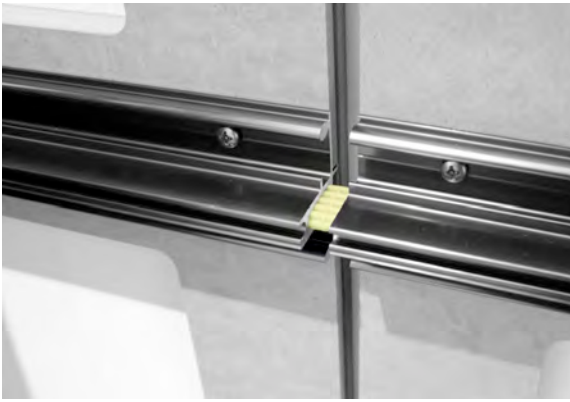

Step 11

To install the next Workwall Structure section, simply lift into place and slip the yellow alignment pins into corresponding rail of the previous mounted section. Make sure that the seam between the two sections is tight without gaps.

Repeat Steps 7-11 for the remaining Workwall Structure sections.



Step 12

After all Workwall Structure sections have been mounted, they then must be shimmed to be made flat and true across all of the mounted panels.



Step 13

Place a level or long straight edge along the front surface of each of the Workwall rails to show the dips or protruding areas.

Warning: If the panel assembly is not flat and free of any dips or bulges there may be issues in securing panels or hanging components properly.



Step 14

The ¼" – 20 bolts use to attached the Workwall sections can be loosened and a shim can be added between the wall and the Workwall section to bring out any low spots.

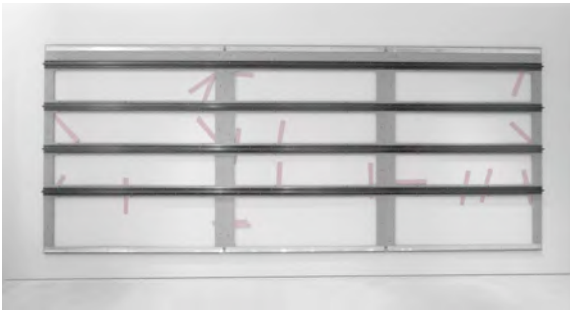

Step 15

It is very important that the Workwall sections are very straight from side to side. Any contour along the length of the Workwall rails will make the remaining installation more difficult.



Step 16

With the Workwall Structure level, flat and mounted secure, it is time to install the Workwall Panels. The number of panels will vary depending on the setup. The bottom edge of the Workwall Panel is marked with a letter and a number. Always work from left to right, top to bottom. The letter on the bottom of the panel indicates its position left to right. The number on the bottom of the panel indicates its position top to bottom. Letter A will be the leftmost panel. Number A1 will be the top left panel.

To install the Workwall Panels, simply align between the proper aluminum rails on the Workwall Structure, and push in place. There will be a positive engagement between the Workwall Panels and the Workwall Structure. Continue the process working left to right, bottom to top until all panels are installed.



Step 17

Once all of the Workwall Panels are installed we recommend that any overhead unit is installed next. This will allow for any lighting wires to be run prior to the installation of the end caps.



Step 18

Workwall mounted items attach to the Workwall by locking the Workwall rails into a mating extrusion on the mounted component. Simply lift the mounting item to the desired attachment rail and rotate upward to a 45° angle. The mating extrusion should slide into the Workwall rail. Slowly rotate the mounting item back to level while keeping pressure toward the Workwall.

Make sure to check that the full length of the mounting item is engaged into the Workwall Rail.



Step 19

Once the component is hung make sure that the two extrusions are fully engaged. If there are any dips in the Workwall Structure it may cause the extrusions to not fully engage.

This is a critical step – please verify.



Step 20

This step can be done before or after an overhead is installed.

To install the LED Light Rail, scribe a line 6" back from the front edge of the shelf or overhead. Space the Light Rail Mounting Brackets evenly over the entire length of the Light Rail. Attach the Light Rail Mounts following the instructions printed on each one.



Step 21

Slide the LED Light Rail into place, keeping the front edge close to the underside of the shelf or overhead. The front edge of the Light Rail Mount Brackets will catch the LED Light Rail. Rotate the back edge up toward the underside of the shelf or overhead and push upward until the Mounting Brackets click. Pressure is best applied directly underneath the Mounting Brackets.

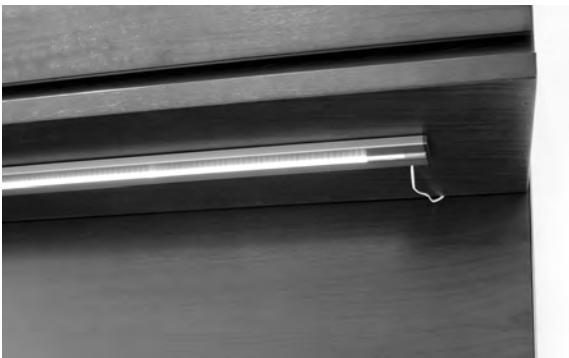

Step 22

After the LED Light Rail is mounted, run the low voltage power line behind the overhead unit and to the closest end where it can be run down to the floor before the end caps are installed.

To secure the power line behind the overhead, swing the overhead out a little so you can loop the line over the spacers on the back of the overhead.



Step 23

Identify the top Workwall Trim Cap. Place the Trim Cap on the top of the Workwall Structure and line up the two ends to the proper positions.

Using a rubber mallet, gently knock the extrusion in place. The T-slot barb on the Trim Cap will fit into a groove along the Workwall Structure.



Step 24

After the top Trim Cap is installed, the side Trim piece can be attached next. It is recommended to wait until after all lighting and wiring is completed to do this. The low voltage wire from task lights is able to run down the sides of the Workwall and should be taped in place before attaching the Trim Caps.



Step 25

Once the top and end caps are installed the remaining components can be moved into place and the office completed.

IMPORTANT NOTES

Failure to install product according to installation instruction will result in loss of warranty.
 Cartons contain all hardware required for assembly.

Machine screws



Glass Run-Off Desk Installation

These illustrations show the assembly process for installing a glass run-off desk.

Please note that the glass run-off desks can only be mounted to a workwall structural rail.

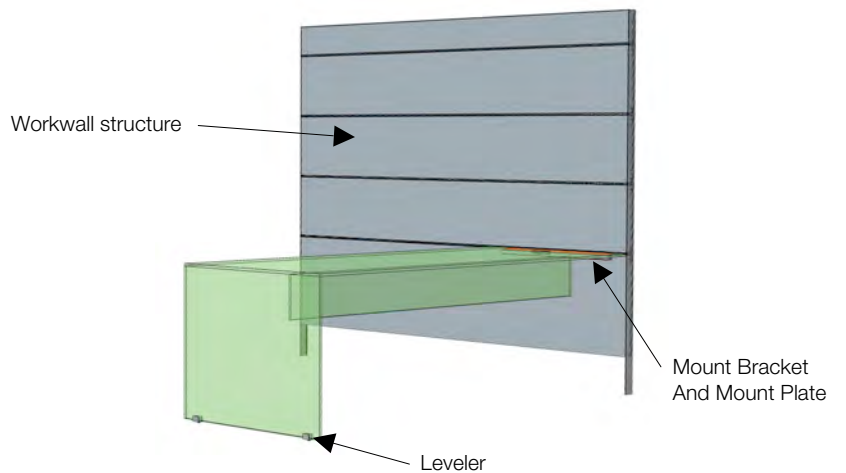

Insert the included aluminum mount bracket into workwall rail and let it hang flat.

Press the back edge of the runoff against the aluminum mount bracket and let it rest on the horizontal leg.

Align the countersunk holes in the mount bracket with the tapped holes in the mount plate.

Thread the provided machine screws into each hole and tighten.

Be sure runoff is completely secure to mounting bracket.

Level runoff as needed.

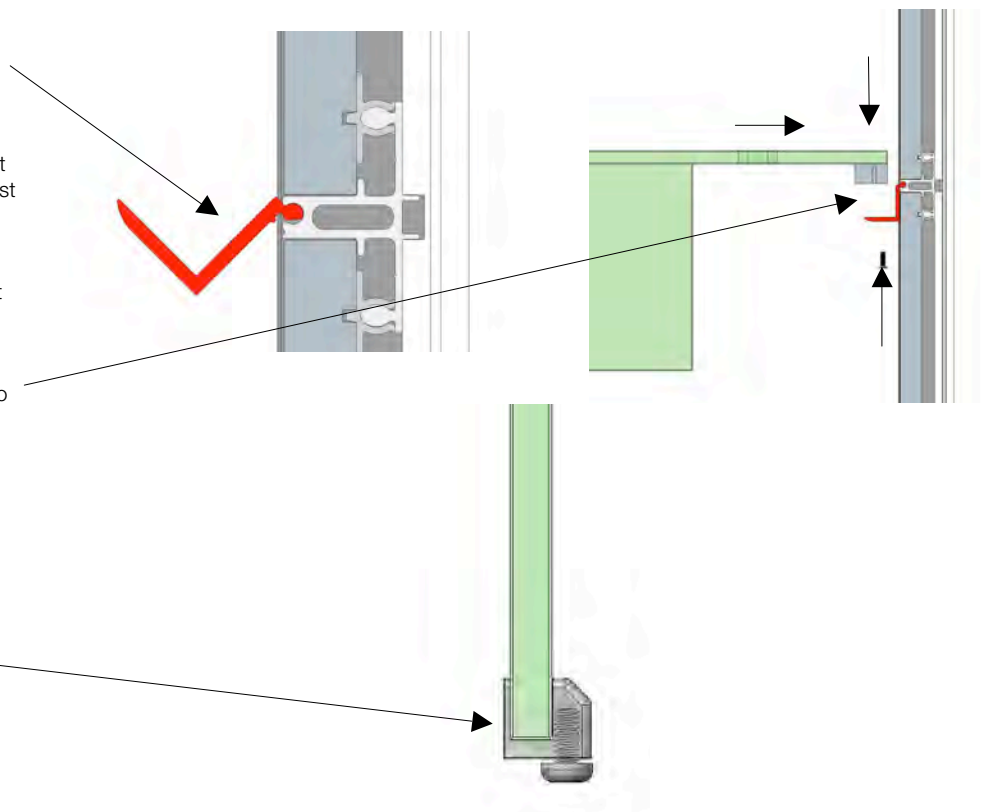

IMPORTANT NOTES

Failure to install product according to installation instruction will result in loss of warranty.
Cartons contain all hardware required for assembly.

Drill Fixture



Mod-eez® Post



Sex Bolts



Deck Assembly Instructions Using a Loop/Panel Support and a Tower

The illustrations here show the assembly process for connecting a loop or panel support end and a tower to a wood deck panel.

Mod-eez® clip installed into the end of the wood deck panel.

2 Mod-eez® post installed in wood loop (this could also be a veneer panel end).

Attach loop support to deck panel by aligning posts in loop with clips in panel and then sliding loop upwards until the posts fully engage.

Mod-eez® clip installed into the end of the wood deck panel.

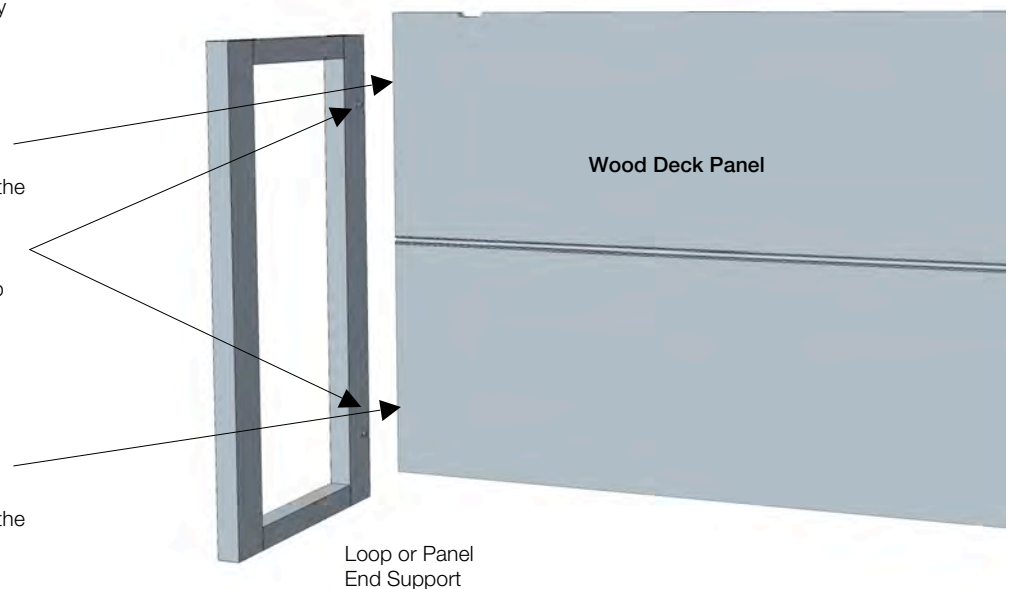

When posts are fully engaged the top of the deck panel will align with the top of the loop support.

Support panel should fit tight and square to the wood deck panel.

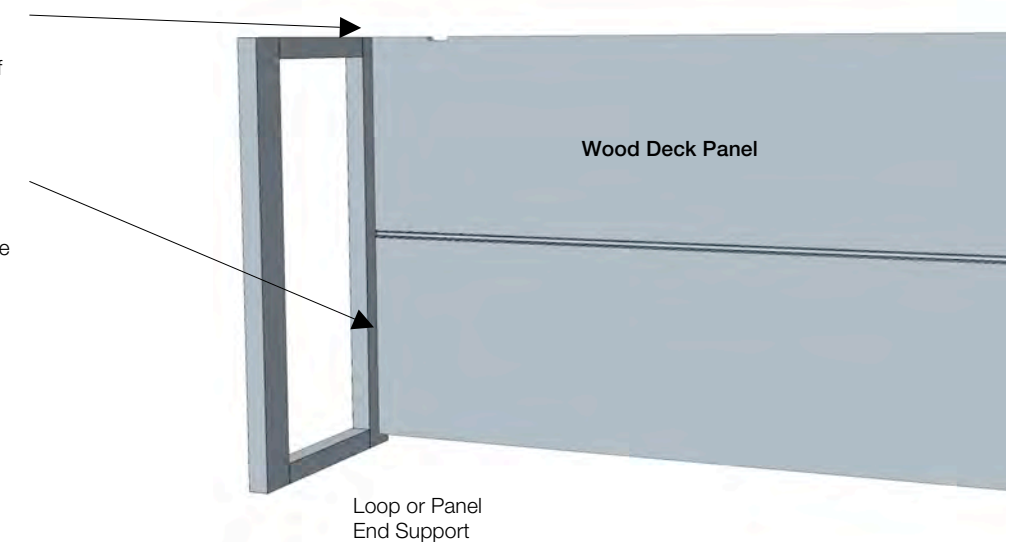

The illustration here show the machining necessary for connecting a wood deck panel to a worksurface tower unit.

Measure from the top back edge of the tower to locate where the holes are to be drilled for the Mod-eez® posts.

Using a 5mm drill bit drill two 13mm (1/2") deep holes for the Mod-eez® posts in the specified locations.

Screw the Mod-eez® posts into the machined holes.

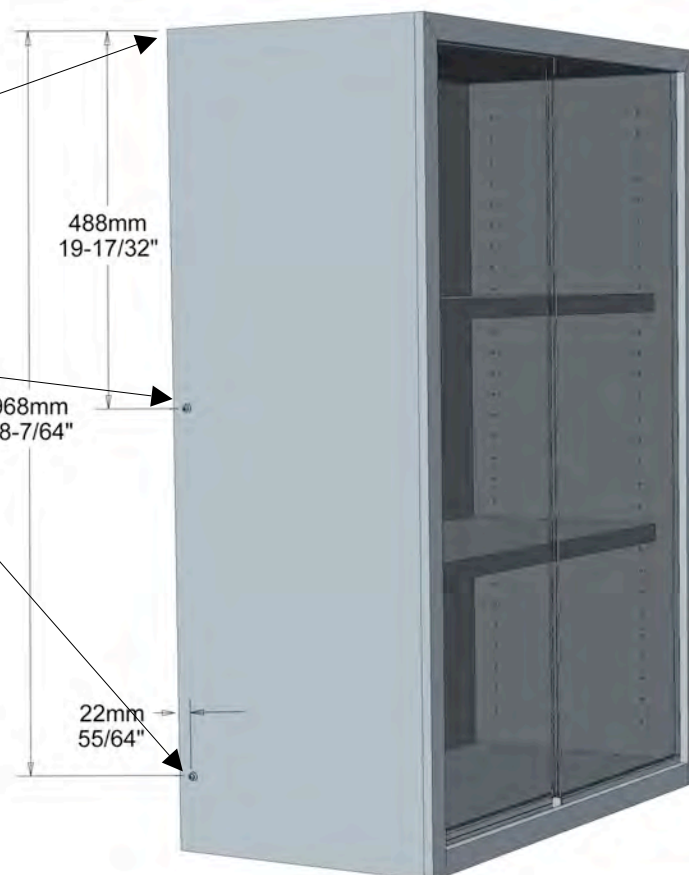

These illustrations show the final assembly process of the wood deck panel to a tower.

If another support end is specified in the place of the tower shown, just repeat the procedure from page 1.

In step 1 take the wood deck panel / loop panel end assembly and lift it up so that it will engage into the Mod-eez® clips.

Once the assembly is engaged in the clips then step 2 is to push this assembly down carefully until the posts and clips are fully engaged and locked into place.

Mod-eez® clip installed into the end of the wood deck panel.

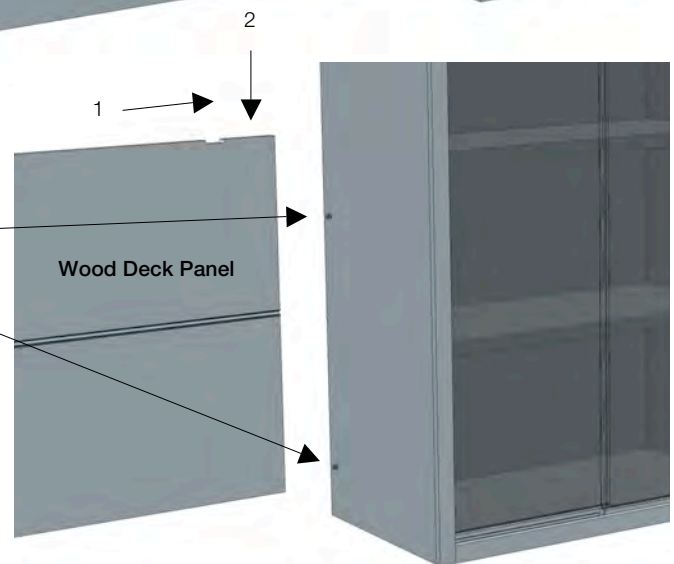
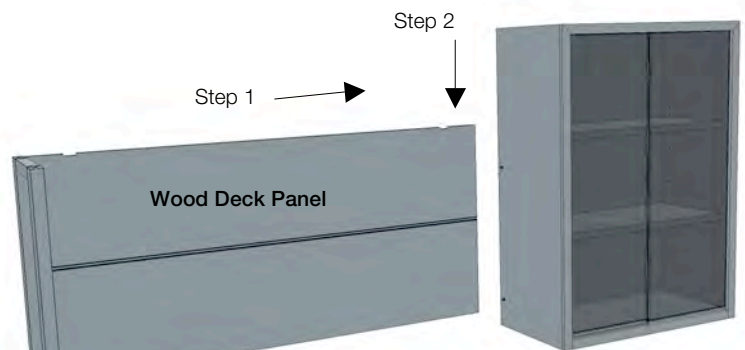

Completed bottom assembly
Next step is the installation of the overhead cabinet.

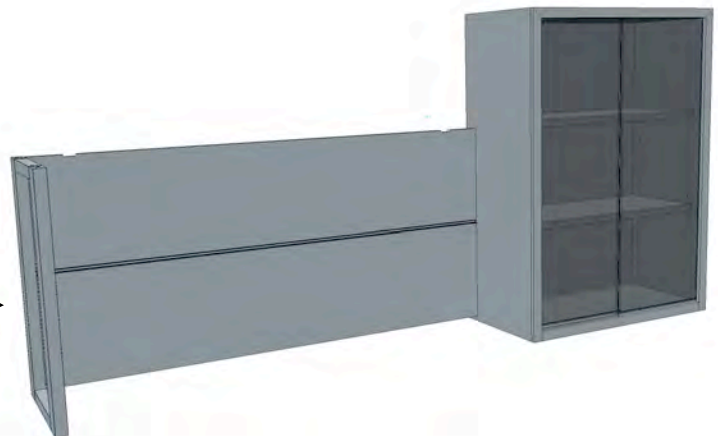

These illustrations show the machining of an overhead cabinet for connection to a support tower.

To assemble a loop support to the underside of the overhead you must first pre-drill and install the Mod-eez® posts.

Use the plastic drill-jig provided. Using a 5mm drill bit drill two 13mm (1/2") deep holes into the underside of the overhead for the Mod-eez® posts.

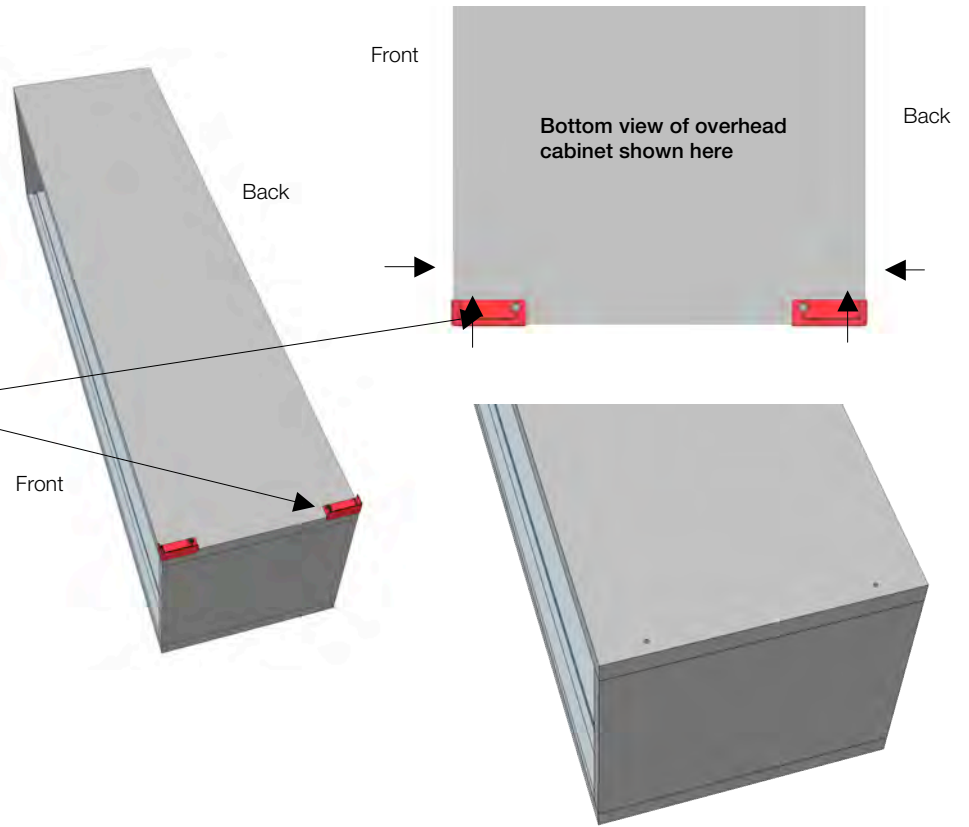

Screw the Mod-eez® posts into the machined holes.

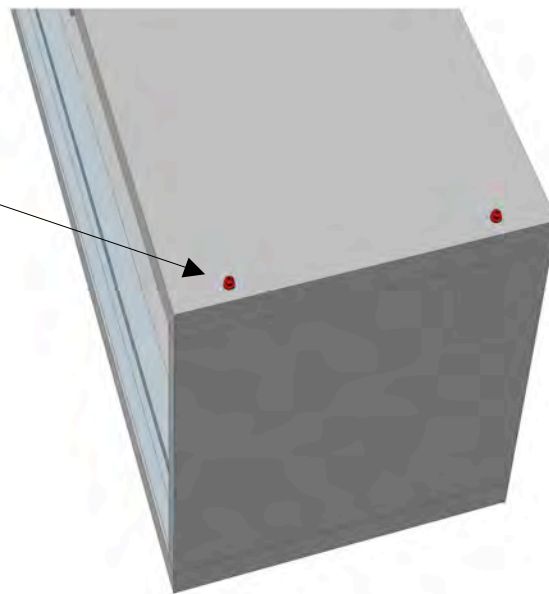

This illustration shows the assembly of the deck structure to the loop or panel end support.

Stand the bottom assembly with the wood deck panel and its end upright either on the floor or on the worksurface where you can get easy access to the connectors.

Step 1 is to lift the overhead above the bottom deck assembly and push it slightly behind the assembly. Rest the overhead on the loop support with the Mod-eez® posts aligned in Mod-eez® clips.

Step 2 is to push the loop support back until the posts lock into the clips and the front of the overhead aligns with the front of the support.

If assembling one side of the overhead to a tower be sure to support that end while assembling the support to the overhead.

Worksurface tower cabinet shown in the background. See the next page for your final step in completing this assembly.

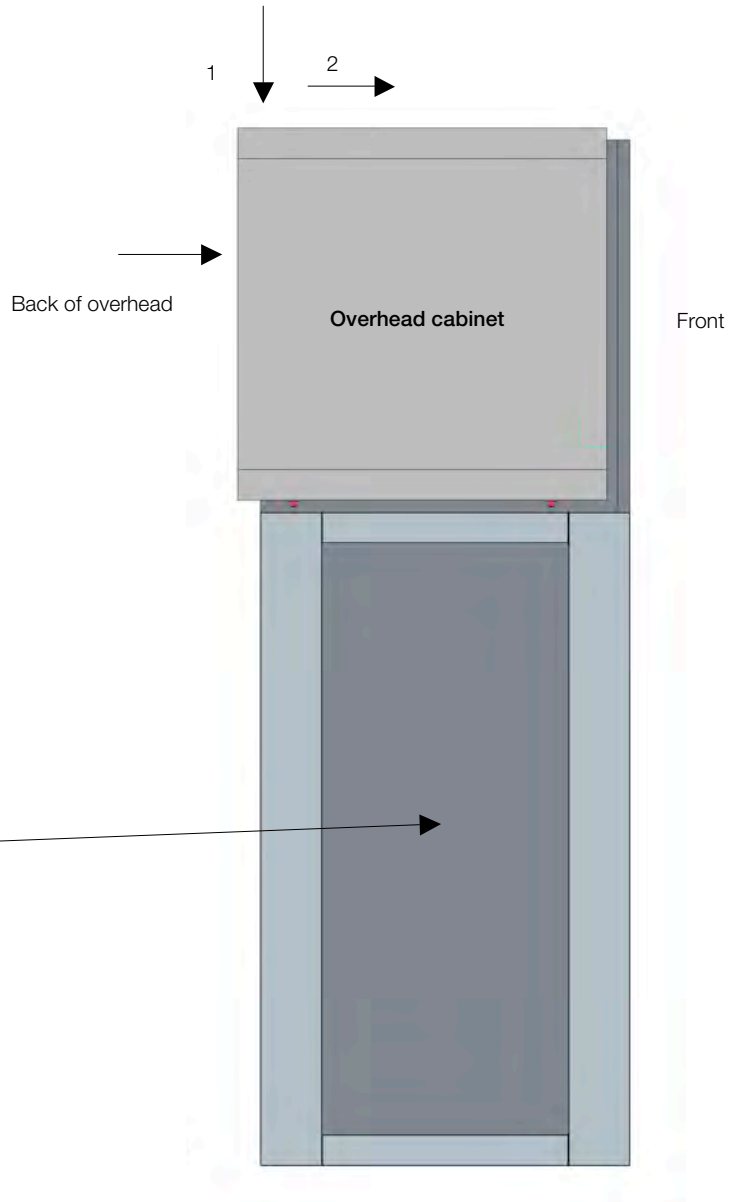

The illustrations shown on this page show the final process of the deck assembly

Align the top and front of the overhead to the tower. Use clamps to keep the units together to ensure proper alignment.

Use a 3/8" drill bit to drill through the top shelf pin hole and through the side panel on the overhead. **Use caution not to blow out the inside face of the overhead.**

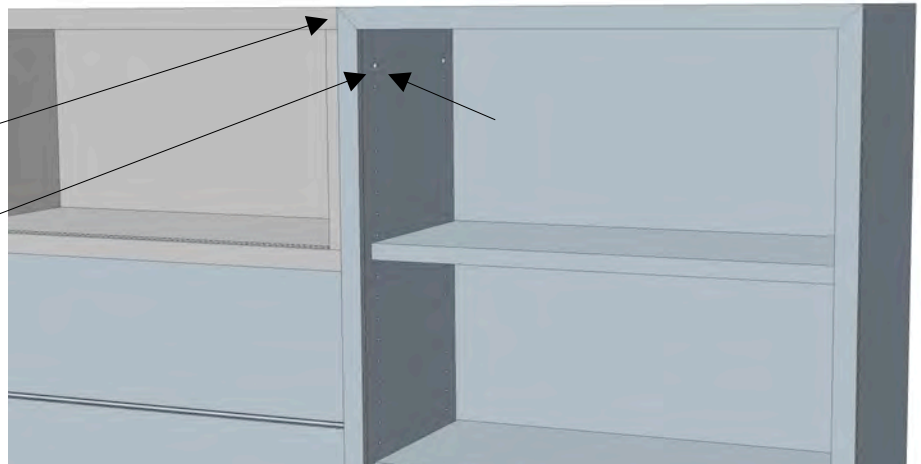

Once holes are drilled, insert sex bolts and tighten while making sure the front and top edges are aligned and flush.

Remove clamps and assembly is complete. Lift and move assembly into place.

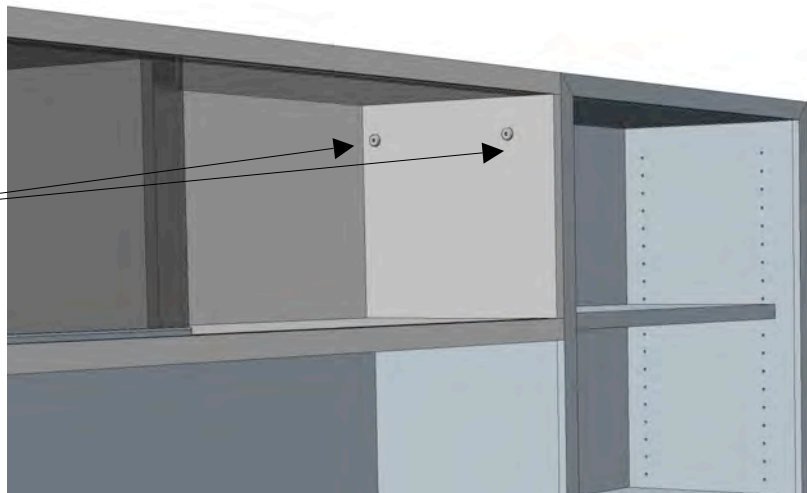

Note: It is better to install any lighting and run the wires through the provided wireway holes on the wood deck panel before the assembly is moved back to the wall.



Completed assembly

IMPORTANT NOTES

Failure to install product according to installation instruction will result in loss of warranty.

Cartons contain all hardware required for assembly.

#8 Wood Screws



Loop Run-off Base and Upholstered Modesty Panel Installation

Illustrations are shown with both the wood loop run-off base as well as the optional upholstered modesty panel.

Location of upholstered modesty panel (Optional).

Mount wood loop base to underside of top with attached brackets. Flush leg to the outside of the table top.

To install the upholstered modesty panel locate as per the dimensions shown and attach to the underside of the top with included #8 wood screws making sure to keep the face of the modesty panel parallel with the edge of the top.

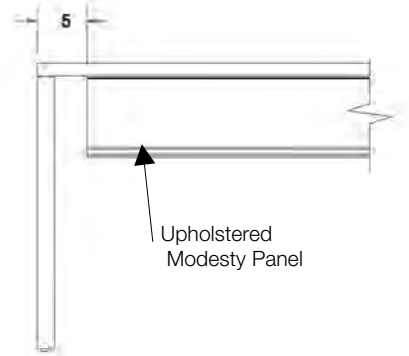
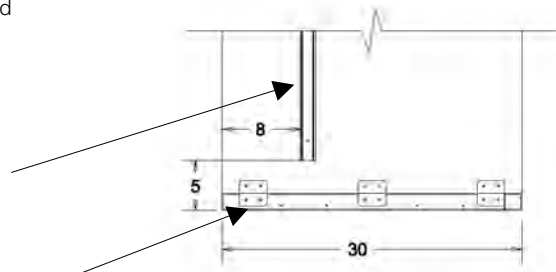

30" Wood Loop Base

Location of upholstered modesty panel.

Mount wood loop base to underside of top with attached brackets. Flush leg to the outside of the table top.

To install the upholstered modesty panel locate as per the dimensions shown and attach to the underside of the top with included #8 wood screws making sure to keep the face of the modesty panel parallel with the edge of the top.

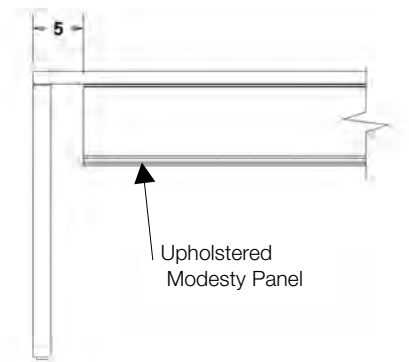
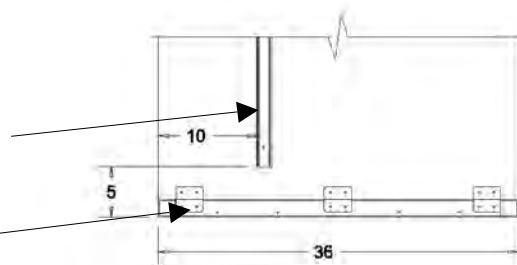

36" Wood Loop Base

IMPORTANT NOTES

Failure to install product according to installation instruction will result in loss of warranty.

Cartons contain all hardware required for assembly.

#8 Wood Screws



C-Base and Wood Veneer Modesty Panel Installation

Illustrations are shown with both the c-base as well as the optional wood veneer modesty panel.

Location of wood veneer modesty panel (Optional).

Mount c-base to underside of top through the top plate of the base. Locate the base by the dimensions shown.

To install the wood modesty panel align the face of the wood veneer panel to the back or user side of the c-base. Locate the panel so that it runs parallel to the edge of the top and attach it to the underside of the top with the attached angle brackets.

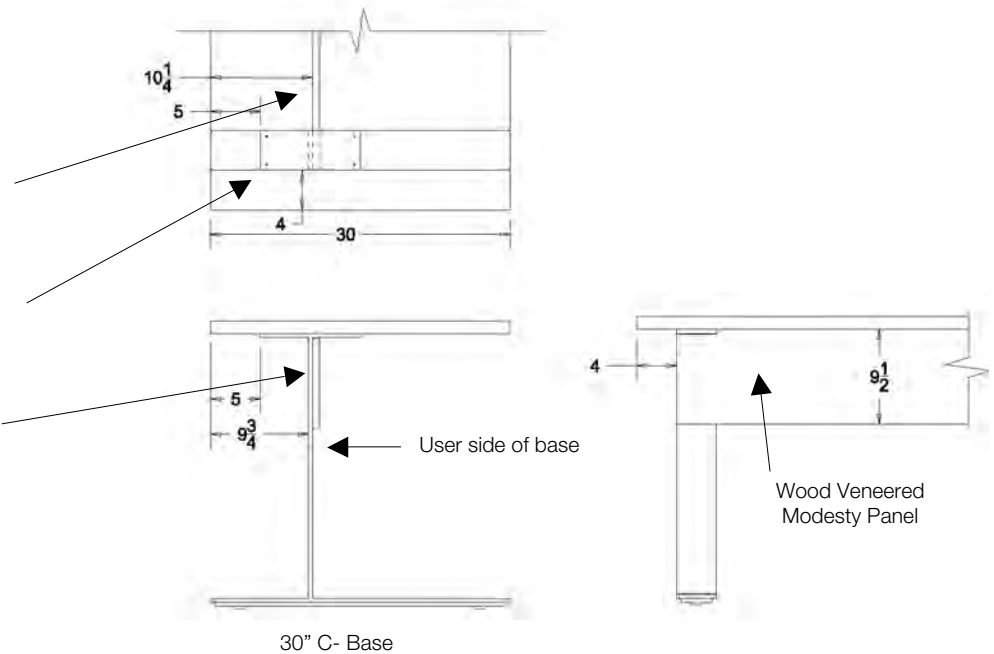

30" C- Base

Location of wood veneer modesty panel (Optional).

Mount c-base to underside of top through the top plate of the base. Locate the base by the dimensions shown.

To install the wood modesty panel align the face of the wood veneer panel to the back or user side of the c-base. Locate the panel so that it runs parallel to the edge of the top and attach it to the underside of the top with the attached angle brackets.

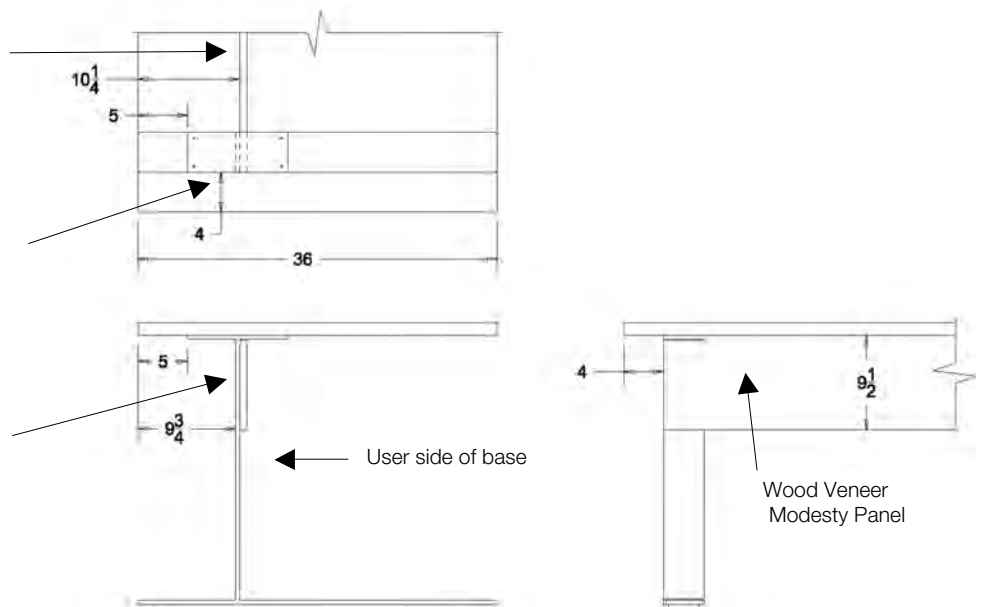

36" C-Base

IMPORTANT NOTES

Failure to install product according to installation instruction will result in loss of warranty.

Cartons contain all hardware required for assembly.

#8 Wood Screws



T- Base and Upholstered Modesty Panel Installation

Illustrations are shown with both the t-base as well as the optional upholstered modesty panel.

Location of upholstered modesty panel (Optional).

Mount t-base to underside of top through the top plate of the base. Locate the base by the dimensions shown.

To install the upholstered modesty panel locate as per the dimensions shown and attach to the underside of the top with included #8 wood screws making sure to keep the face of the modesty panel parallel with the edge of the top.

Level the base as needed.

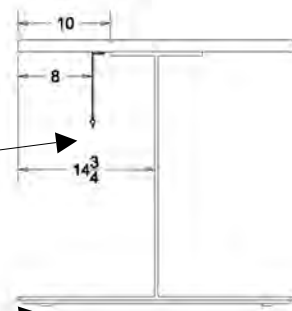
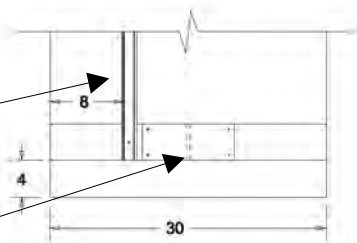

30" T- Base

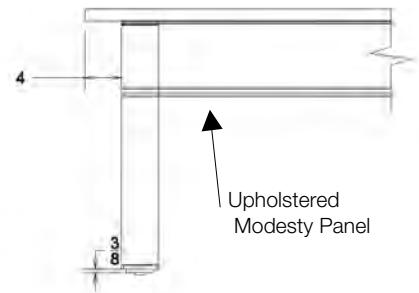

Upholstered Modesty Panel

Location of upholstered modesty panel (Optional).

Mount wood loop base to underside of top with attached brackets. Flush leg to the outside of the table top.

To install the upholstered modesty panel locate as per the dimensions shown and attach to the underside of the top with included #8 wood screws making sure to keep the face of the modesty panel parallel with the edge of the top.

Level the base as needed.

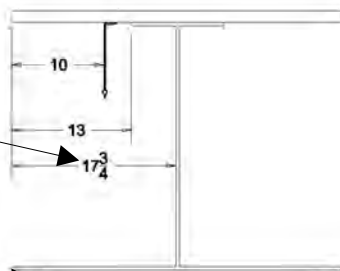
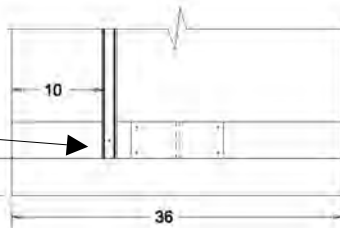

36" T- Base

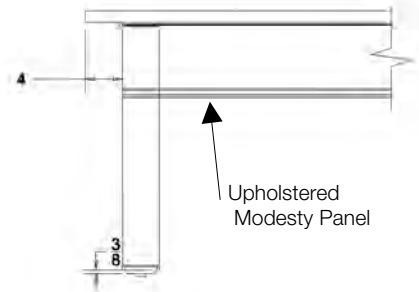

Upholstered Modesty Panel

IMPORTANT NOTES

Failure to install product according to installation instruction will result in loss of warranty.

Cartons contain all hardware required for assembly.

#8 Wood Screws



Easel Base and Upholstered Modesty Panel Installation

Illustrations are shown with both the easel run-off base as well as the optional upholstered modesty panel.

Location of upholstered modesty panel (Optional).

Mount easel base to underside of top with attached brackets. Locate by dimensions shown.

To install the upholstered modesty panel locate as per the dimensions shown and attach to the underside of the top with included #8 wood screws making sure to keep the face of the modesty panel parallel with the edge of the top.

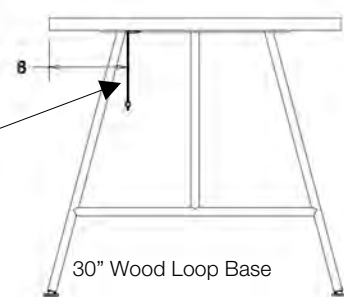
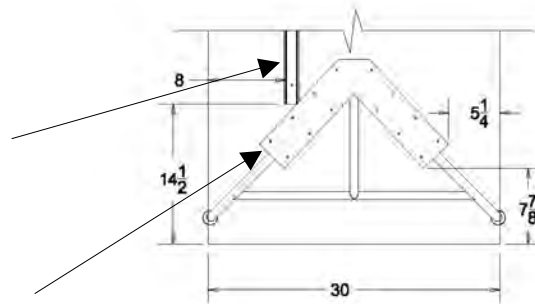

30" Wood Loop Base

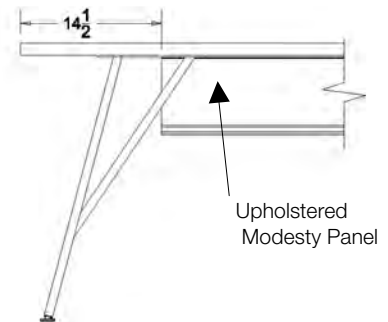

Location of upholstered modesty panel.

Mount wood loop base to underside of top with attached brackets. Flush leg to the outside of the table top.

To install the upholstered modesty panel locate as per the dimensions shown and attach to the underside of the top with included #8 wood screws making sure to keep the face of the modesty panel parallel with the edge of the top.

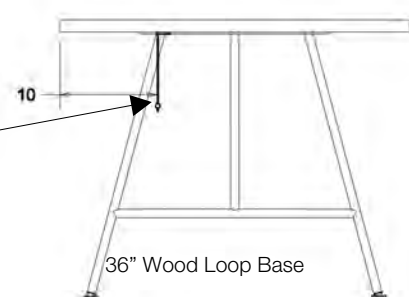
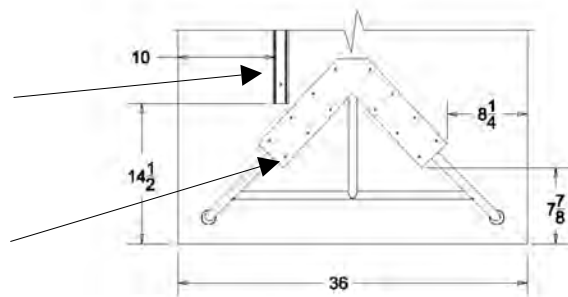

36" Wood Loop Base

