

network credenzas

May 2018 Price List

index	2
collection overview	3
materials/finishes	4
ordering guide/product selection sequence	4
storage credenzas 22"d complete assembly	5
storage credenzas 22"d	6
tops - glass/solid surface 22"d	7
av/refrigerator credenzas 25"d complete assembly	8
av/refrigerator credenzas 25"d	9
tops - glass/solid surface 25"d	10
av rotating/slideout equipment rack	11
guaranteed freight	12
terms and conditions	13-14

**Network Credenzas**

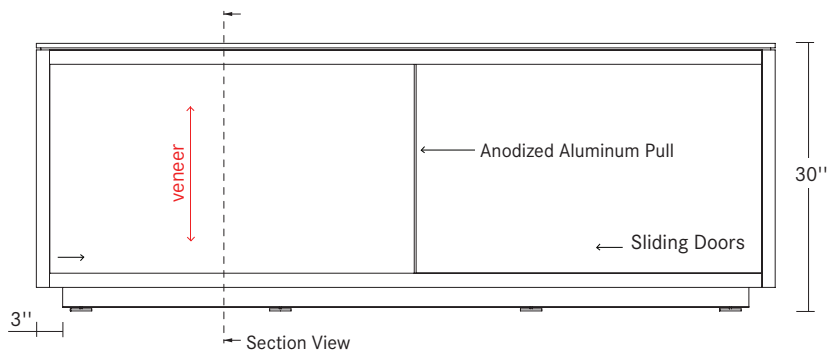

**Front View/Standard Height**

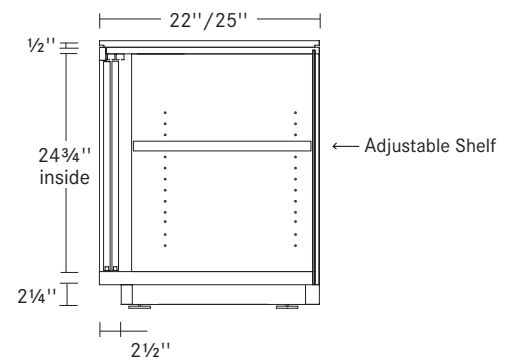

**Section View/Standard Height**

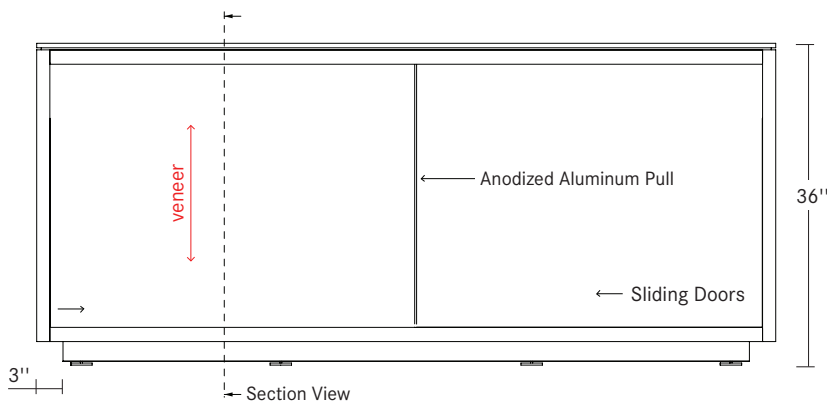

**Front View/Serving Height**

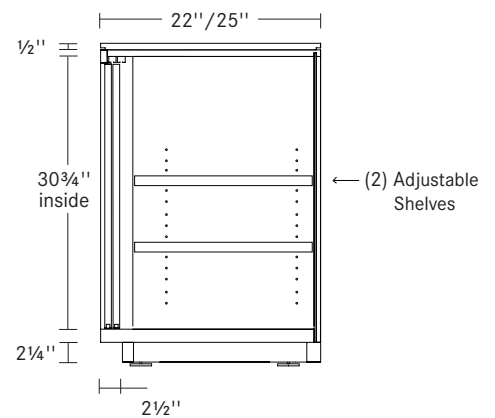

**Section View/Serving Height**

**AV/Refrigerator Credenza**

The Network av/refrigerator credenzas are designed to accommodate refrigeration needs and audiovisual equipment use and storage. Each av/refrigerator credenza comes standard with a vented, thermal sensor cooling fan installed. AV rotating/slideout equipment racks are available for installation, allowing for more flexibility and usage of space. **Refrigerators are not available for purchase from Bernhardt Design and must be purchased separately.**

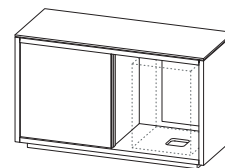

**Front View**  
AV/Refrigerator Credenza

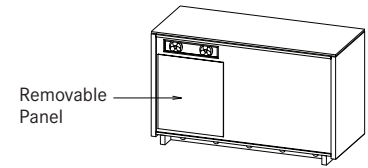

**Back View**  
Showing Removeable Back Panel

**AV Rotating/Slideout Equipment Rack**

Rack max weight capacity: 200 lbs.  
Rail System: 19" overall depth, 38" extended  
AV rack must be screwed to the bottom of the case when installed.

**Standard Height:**  
12 usable rack spaces  
Usable Depth: 15 1/2"  
Usable Width: 18 1/2"

**Serving Height:**  
14 usable rack spaces  
Usable Depth: 15 1/2"  
Usable Width: 18 1/2"

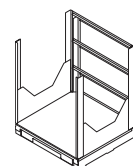

**Front View**  
AV Rotating/Slideout Equipment Rack

**Materials/Finishes**

A three character sku identifies each species as well as the standard finish offered. Individual components are priced with standard finish. Special finishes on veneers made to customer specifications are subject to factory approval and a 5% net upcharge with a \$500 net minimum.

Transparent stains and sealers are applied in multiple steps to enhance the beauty of the natural wood. A durable, baked-on, top-coat of

conversion varnish or UV topcoat is applied to protect the product. It is recommended that felt, cork or fabric backed desk pads and accessories are used on tops to minimize wear.

When specifying light finishes such as 836, 837, 840, 850 or 870, the color and characteristic variances of both veneer and solid wood are apparent. Therefore, exact color matches are not possible.

**Veneer Selections**



**FL** 1/2" Flat Edge

**Tops**

**CHY** Cherry

**MPL** Maple

**WLT** Walnut

Flat Cut

**OAK** Oak

Rift

**Credenzas**

**CHY** Cherry

**MPL** Maple

**WLT** Walnut

Quarter Cut

**OAK** Oak

Rift

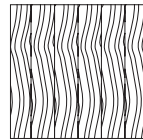
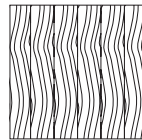
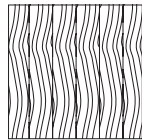
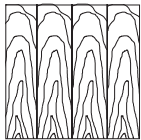

**Standard Finishes**

<b>CHY</b> Cherry	<b>MPL</b> Maple	<b>WLT</b> Walnut	<b>OAK</b> Oak
805	837	823	805
834	850	839	836
836		841	837
839		860	839
840		861	840
841		866	860
861		870	861
			865
			866
			870

**Glass Selections - Tops**



**PL** 1/2" Polished Flat Edge

**GPW** Back-Painted White Glass - Top

**GEW** Etched, Back-Painted White Glass - Top

**Solid Surface Selection - Tops**



**FL** 1/4" Flat Edge

**SSF** Solid Surface

**Standard Finish**

**CGW** Corian, Glacier White

**Pull/Hardware Selection**

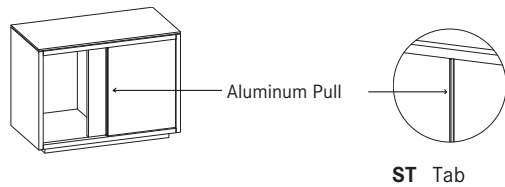

**Ordering Guide/Product Selection Sequence**

1. Select credenza depth
2. Select credenza type: assembly or credenza
3. Select standard or serving height
4. Select top material if credenza is specified
5. Select any required accessories

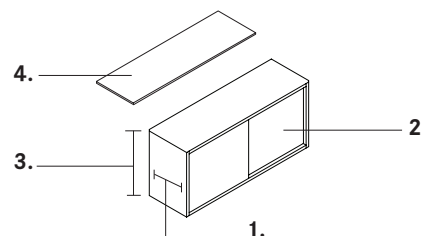

**storage credenzas assemblies 22"d**



**storage credenzas assemblies 22"d**

includes 22"d, 1/2"h veneer top

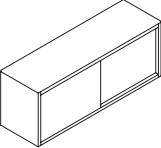
description	sku	w	d	h	specifications	CHY cherry
						MPL maple
 <p><b>standard height credenza</b></p> <p>2 sliding doors 1 polished aluminum pull 1 adjustable shelf</p>	CLA	48	22	30	no locks	\$ 5030
	CLB	54	22	30	no locks	5358
	CLC	60	22	30	no locks	5562
	CLD	66	22	30	no locks	5763
	CLE	72	22	30	no locks	6153
	CLF	78	22	30	no locks	6358
	CLG	84	22	30	no locks	6896
	CLH	90	22	30	no locks	7119
	CLI	96	22	30	no locks	7339
	CLJ	102	22	30	no locks	7806
	CLK	108	22	30	no locks	8026

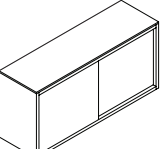
 <p><b>serving height credenza</b></p> <p>2 sliding doors 1 polished aluminum pull 1 adjustable shelf</p>	CHA	48	22	36	no locks	5214
	CHB	54	22	36	no locks	5552
	CHC	60	22	36	no locks	5771
	CHD	66	22	36	no locks	5989
	CHE	72	22	36	no locks	6388
	CHF	78	22	36	no locks	6604
	CHG	84	22	36	no locks	7172
	CHH	90	22	36	no locks	7407
	CHI	96	22	36	no locks	7639
	CHJ	102	22	36	no locks	8120
	CHK	108	22	36	no locks	8355

specification codes example: CSS-SKU-FL

series	sku	edge
network		FL 1/4" flat
C   S   S   -	-	F   L

material/finish code example: WLT 839

material	finish
CHY cherry	see page 4
MPL maple	
OAK oak	
WLT walnut	

storage credenzas 22"d



storage credenzas 22"d

for use with 22"d glass, solid surface or com tops  
specify top separately

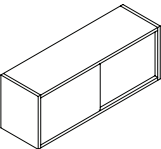
description	sku	w	d	h	specifications	CHY	cherry
						MPL	maple
 <p><b>standard height credenza</b> 2 sliding doors 1 polished aluminum pull 1 adjustable shelf</p>	HLA	48	22	30	no locks		\$ 4618
	HLB	54	22	30	no locks		4924
	HLC	60	22	30	no locks		5105
	HLD	66	22	30	no locks		5285
	HLE	72	22	30	no locks		5651
	HLF	78	22	30	no locks		5832
	HLG	84	22	30	no locks		6343
	HLH	90	22	30	no locks		6540
	HLI	96	22	30	no locks		6761
	HLJ	102	22	30	no locks		7185
	HLK	108	22	30	no locks		7381

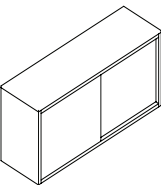
description	sku	w	d	h	specifications	CHY	cherry
						MPL	maple
 <p><b>serving height credenza</b> 2 sliding doors 1 polished aluminum pull 2 adjustable shelves</p>	HHA	48	22	36	no locks		4799
	HHB	54	22	36	no locks		5117
	HHC	60	22	36	no locks		5312
	HHD	66	22	36	no locks		5504
	HHE	72	22	36	no locks		5925
	HHF	78	22	36	no locks		6076
	HHG	84	22	36	no locks		6617
	HHH	90	22	36	no locks		6824
	HHI	96	22	36	no locks		7035
	HHJ	102	22	36	no locks		7494
	HHK	108	22	36	no locks		7705

specification codes example: CSS-SKU-00

series	sku	edge
network		00 none
C   S   S   -	-	0   0

material/finish code example: WLT 839

material	finish
CHY cherry	see page 4
MPL maple	
OAK oak	
WLT walnut	

tops - glass/solid surface 22"d

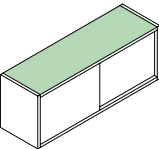

tops - glass/solid surface 22"d

description	sku	w	d	h	GPW	GEW etched
					back-painted white glass	back-painted white glass
 <p><b>glass top 22"d</b></p> <p>1/2" glass top has veneer edge band subtop construction specify material code GPW or GEW specify subtop code and subtop finish code</p>	GLA	48	22	1/2	\$ 1910	\$ 2331
	GLB	54	22	1/2	2080	2538
	GLC	60	22	1/2	2223	2713
	GLD	66	22	1/2	2393	2920
	GLE	72	22	1/2	2559	3122
	GLF	78	22	1/2	2729	3330
	GLG	84	22	1/2	2946	3595
	GLH	90	22	1/2	3089	3769
	GLI	96	22	1/2	3259	3976
	GLJ	102	22	1/2	3422	4175
	GLK	108	22	1/2	3565	4350

specification codes example: AKS-SKU-PL

series	sku	edge
network		PL 1/4" polished flat
C   S   S   -	-	P   L

material/finish code example: GPW CHT 805

material	subtop	subtop finish
GPW glass back-painted white GEW glass etched back-painted white	PNT paint CHY cherry MPL maple OAK oak	see page 4

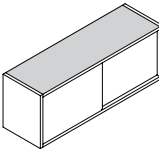
description	sku	w	d	h	SSF solid surface*
 <p><b>solid surface top 22"d</b></p> <p>1 1/4" h solid surface top</p>	SFA	48	22	1 1/4	\$ 1613
	SFB	54	22	1 1/4	1762
	SFC	60	22	1 1/4	1905
	SFD	66	22	1 1/4	2048
	SFE	72	22	1 1/4	2191
	SFF	78	22	1 1/4	2347
	SFG	84	22	1 1/4	2510
	SFH	90	22	1 1/4	2653
	SFI	96	22	1 1/4	2823
	SFJ	102	22	1 1/4	3015
	SFK	108	22	1 1/4	3158

specification codes example: CSS-SKU-FL

series	sku	edge
network		FL 1/4" flat
C   S   S   -	-	F   L

material/finish code example: SSF CGW

material	finish
SSF solid surface	CGW glacier white
S   S   F	C   G   W

av/refrigerator credenzas assemblies 25"d



av/refrigerator credenzas assemblies 25"d

includes 25"d, 1¼" veneer top

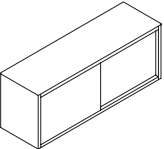
description	sku	w	d	h	specifications	CHY	MPL	OAK	WLT
						cherry	maple	oak	walnut
 <p><b>standard height av/refrigerator credenza</b></p> <p>2 sliding doors 1 polished aluminum pull 1 adjustable shelf removable back panel for av/refrigerator</p>	ALA	48	25	30	1 lock	\$ 5959			
	ALB	54	25	30	1 lock	6280			
	ALC	60	25	30	1 lock	6482			
	ALD	66	25	30	1 lock	6679			
	ALE	72	25	30	1 lock	7064			
	ALF	78	25	30	1 lock	7265			
	ALG	84	25	30	1 lock	7844			
	ALH	90	25	30	1 lock	8063			
	ALI	96	25	30	1 lock	8284			
	ALJ	102	25	30	1 lock	8749			
ALK	108	25	30	1 lock	8967				

Refrigerators are not available for purchase from Bernhardt Design and must be purchased separately

holds 1.5 cubic foot refrigerator  
interior Dimensions: 28½" w x 20½" d x 24¾" h  
specify separately the ACS-VCZ equipment rack

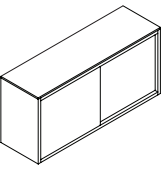
 <p><b>serving height av/refrigerator credenza</b></p> <p>2 sliding doors 1 polished aluminum pull 2 adjustable shelves removable back panel for av/refrigerator</p>	AHA	48	25	36	1 lock	6154			
	AHB	54	25	36	1 lock	6491			
	AHC	60	25	36	1 lock	6703			
	AHD	66	25	36	1 lock	6915			
	AHE	72	25	36	1 lock	7313			
	AHF	78	25	36	1 lock	7526			
	AHG	84	25	36	1 lock	8140			
	AHH	90	25	36	1 lock	8370			
	AHI	96	25	36	1 lock	8603			
	AHJ	102	25	36	1 lock	9081			
AHK	108	25	36	1 lock	9315				

Refrigerators are not available for purchase from Bernhardt Design and must be purchased separately

holds 1.7 cubic foot refrigerator  
interior Dimensions: 28½" w x 20½" d x 30¾" h  
specify separately the ACS-VCY equipment rack

specification codes example: CSS-SKU-FL

series	sku	edge
network		FL 1¼" flat
C   S   S   -	-	F   L

material/finish code example: WLT 839

material	finish
CHY cherry MPL maple OAK oak WLT walnut	see page 4



av/refrigerator credenzas 25"d



av/refrigerator credenzas 25"d

for use with 25"d glass, solid surface or com tops  
specify top separately

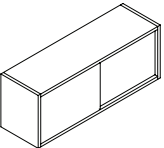
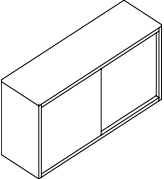
description	sku	w	d	h	specifications	CHY cherry MPL maple OAK oak WLT walnut
 <p><b>standard height av/refrigerator credenza</b></p> <p>2 sliding doors 1 polished aluminum pull 1 adjustable shelf removable back panel for av/refrigerator</p>	KLA	48	25	30	1 lock	5536
	KLB	54	25	30	1 lock	5833
	KLC	60	25	30	1 lock	6008
	KLD	66	25	30	1 lock	6183
	KLE	72	25	30	1 lock	6545
	KLF	78	25	30	1 lock	6717
	KLG	84	25	30	1 lock	7265
	KLH	90	25	30	1 lock	7458
	KLI	96	25	30	1 lock	7652
	KLJ	102	25	30	1 lock	8092
	KLK	108	25	30	1 lock	8288
<p>holds 1.5 cubic foot refrigerator interior Dimensions: 28½"w x 20½"d x 24¾"h specify separately the ACS-VCZ equipment rack</p> <p>Refrigerators are not available for purchase from Bernhardt Design and must be purchased separately</p>						
 <p><b>serving height av/refrigerator credenza</b></p> <p>2 sliding doors 1 polished aluminum pull 2 adjustable shelves removable back panel for av/refrigerator</p>	KHA	48	25	36	1 lock	5728
	KHB	54	25	36	1 lock	6040
	KHC	60	25	36	1 lock	6230
	KHD	66	25	36	1 lock	6416
	KHE	72	25	36	1 lock	6788
	KHF	78	25	36	1 lock	6977
	KHG	84	25	36	1 lock	7555
	KHH	90	25	36	1 lock	7763
	KHI	96	25	36	1 lock	7970
	KHJ	102	25	36	1 lock	8424
	KHK	108	25	36	1 lock	8629
<p>holds 1.7 cubic foot refrigerator interior Dimensions: 28½"w x 20½"d x 30¾"h specify separately the ACS-VCY equipment rack</p> <p>Refrigerators are not available for purchase from Bernhardt Design and must be purchased separately</p>						

specification codes example: CSS-SKU-00

series	sku	edge
network		00 none
C   S   S   -	-	0   0

material/finish code example: WLT 839

material	finish
CHY cherry MPL maple OAK oak WLT walnut	see page 4

tops - glass/solid surface 25"d



tops - glass/solid surface

for use with 25" av/refrigerator credenzas

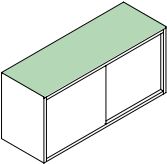
description	sku	w	d	h	GPW	GEW etched
					back-painted white glass	back-painted white glass
 <p><b>glass top 25"d</b> 1/2" glass top has veneer edge band subtop construction specify material code GPW or GEW specify subtop and subtop finish code</p>	GHA	48	25	1/2	\$ 2416	\$ 2948
	GHB	54	25	1/2	2559	3122
	GHC	60	25	1/2	2729	3330
	GHD	66	25	1/2	2946	3595
	GHE	72	25	1/2	3089	3769
	GHF	78	25	1/2	3259	3976
	GHG	84	25	3/4	3422	4175
	GHH	90	25	3/4	3565	4350
	GHI	96	25	3/4	3753	4579

specification codes example: AKS-SKU-PL

series	sku	edge
network		PL 1/4" polished flat
C   S   S   -	-	P   L

material/finish code example: GPW CHT 805

material	subtop	subtop finish
GPW glass back-painted white GEW glass etched back-painted white	PNT paint CHY cherry MPL maple OAK oak	see page 4

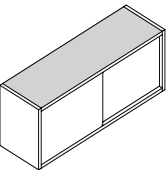
description	sku	w	d	h	SSF solid surface*
 <p><b>solid surface top 25"d</b> 1 1/4" h solid surface top</p>	SHA	48	25	1 1/4	\$ 1774
	SHB	54	25	1 1/4	1937
	SHC	60	25	1 1/4	2103
	SHD	66	25	1 1/4	2268
	SHE	72	25	1 1/4	2462
	SHF	78	25	1 1/4	2633
	SHG	84	25	1 1/4	2786
	SHH	90	25	1 1/4	2951
	SHI	96	25	1 1/4	3116
	SHJ	102	25	1 1/4	3279
	SHK	108	25	1 1/4	3445

specification codes example: CSS-SKU-FL

series	sku	edge
network		FL 1/4" flat
C   S   S   -	-	F   L

material/finish code example: SSF CGW

material	finish
SSF solid surface	CGW glacier white
S   S   F	C   G   W

av rotating/slideout equipment rack

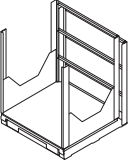
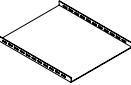
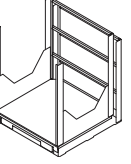
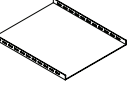
description	sku	w	d	h	specifications	price
 <p><b>standard height av rotating/slideout equipment rack</b></p> <p>use with 30" h av/refrigerator credenzas telescoping depth: 16" - 26" rack max weight capacity: 200 lb. field assembled and installed specify separately the ACS-VCX av shelf</p>	VCZ	19	19-38	24	12 usable rack spaces	\$ 1853
 <p><b>av shelf</b></p> <p>sliding rail system shelf, mounts to rack rails slots for securing components with straps hardware included usable depth: 15½" usable width: 18½" specify separately the ACS-VCZ equipment rack</p>	VCX	19	16¼	1½		517
 <p><b>serving height av rotating/slideout equipment rack</b></p> <p>use with 30" h av/refrigerator credenzas telescoping depth: 16" - 26" max weight capacity: 200 lb. field assembled and installed specify separately the ACS-VCX av shelf</p>	VCY	19	19-38	27½	14 usable rack spaces	1963
 <p><b>av shelf</b></p> <p>sliding rail system shelf, mounts to rack rails slots for securing components with straps hardware included usable depth: 15½" usable width: 18½" specify separately the ACS-VCY equipment rack</p>	VCW	18¾	16¼	1½		340

specification codes example: ACS-SKU

series	sku
accessory	
A   C   S   -	

**Preferred Carrier Guaranteed Freight Rates**

Freight charges will be applied to orders as a separate line item based on the zones listed. Rates are based on zones with a minimum for each zone. All zones are located within the Continental United States.

The freight amount is calculated on the total merchandise net price, excluding any extra discounts beyond standard net pricing. Additional freight fuel surcharges may apply. Rates are based on deliveries made Monday through Friday, 8 am until 5 pm.

All orders are shipped by Bernhardt Design company trucks or preferred carriers specified by Bernhardt Design. Dealer warehouse information, including phone number and contact name, must be specified on the purchase order.

Direct site deliveries may be requested with an additional freight cost. Requests for direct site deliveries must be made 2 weeks prior to the scheduled ship week and meet the following criteria:

- Minimum of half truckload
- Delivery site accessible by a 53' trailer
- Complete delivery site address with contact name and on-site phone number
- Labor available for unloading

Deliveries that do not meet the criteria must be directed to a receiver warehouse. If a receiver warehouse is not available, the dealer may make arrangements with their own 3rd party carrier. If a 3rd party carrier is elected, a contact name, phone number and e-mail address is required.

Weekend direct site deliveries will incur a \$500 per trailer weekend delivery fee. Weekend is

Zone	Minimum Charge	Freight Rate	Average Service Days
1	\$80	5%	2-4 Business Days
2	\$80	6%	2-4 Business Days
3	\$90	7%	3-5 Business Days
4	\$90	8%	5-7 Business Days
5	\$90	9%	6-9 Business Days
6	\$110	10%	6-9 Business Days
7	\$110	11%	7-10 Business Days
8	\$120	12%	8-12 Business Days
9	\$120	13%	8-12 Business Days
10	\$120	15%	10-15 Business Days

**Note:** Average Service Days excludes ship day.

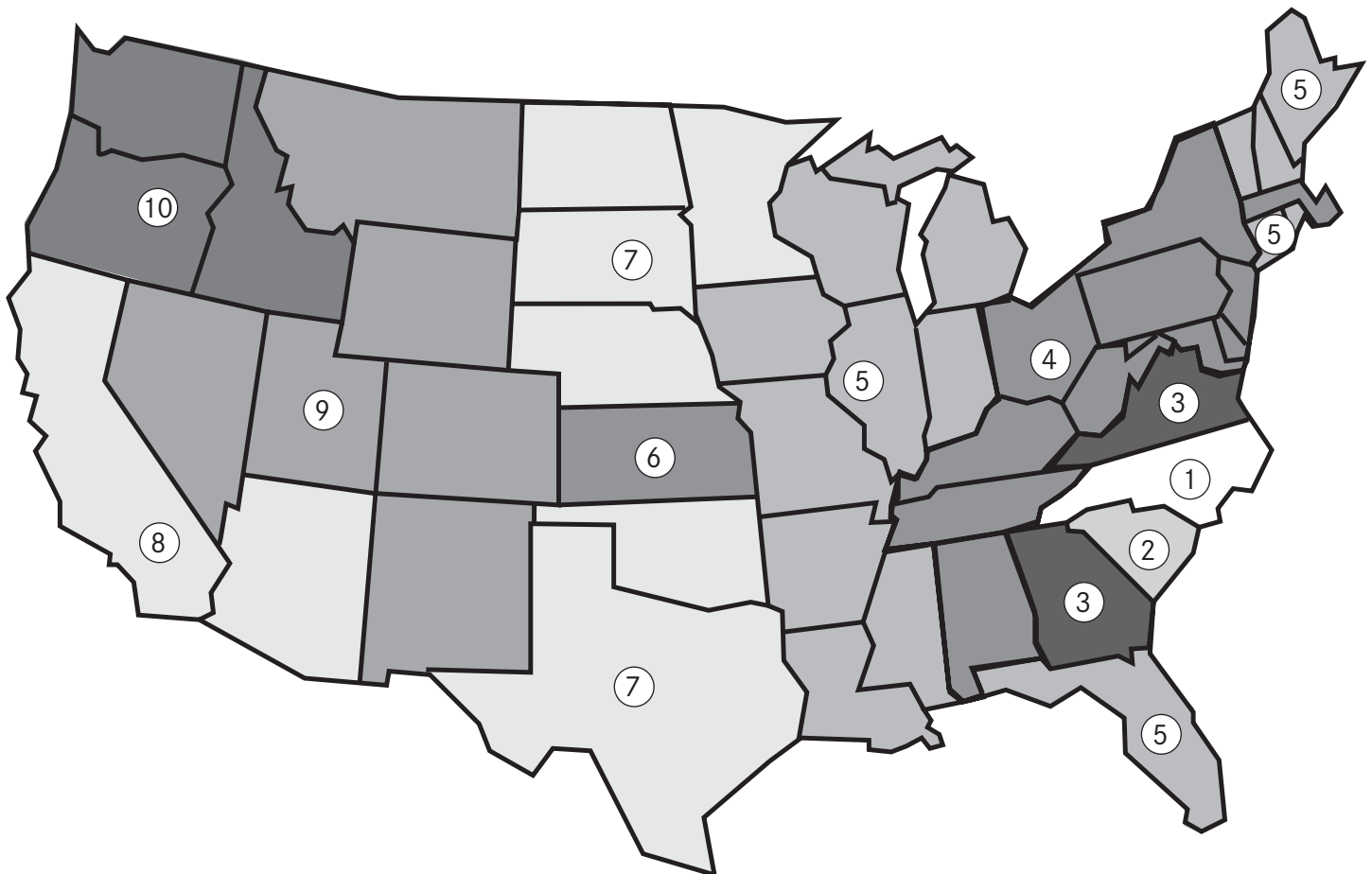

**Sales and Service Policy**

Guidelines detailing the operating policies and procedures of Bernhardt Design are provided in the Sales and Service Policy available online at <http://www.bernhardtdesign.com/sales-and-service-policy>.

**Prices and Specifications**

Prices and specifications are subject to change without notice. All prices quoted will be FOB our factories. If applicable, sales tax will be based on ship-to destination.

Bernhardt Design reserves the right to make changes in dimensions, construction, price lists, or product literature without prior notice.

**Order Entry**

All orders are subject to final acceptance by Bernhardt Design in Lenoir, NC. Receipt of our acknowledgment indicates acceptance of your order subject to the terms set forth on the acknowledgment. Bernhardt Design attempts to clarify all purchase orders. However, in the event the price list number and description on the purchase order differ, the price list number will prevail.

**Changes / Cancellation**

All orders in production are considered firm orders and are not subject to changes or cancellation.

**Custom Design**

Bernhardt Design may alter products to meet specific needs. Contact your local sales representative when a custom design is needed. Custom designs require minimum quantities, additional lead time, and upcharges.

A custom job number, available from your local sales representative, must be submitted with purchase orders. Orders combining custom design with standard product cannot be scheduled for production until custom items are approved. Custom design orders are not subject to revision or cancellation after acknowledgment.

**Shipping**

Bernhardt Design will ship in accordance with customer instructions whenever possible. If not specified, Bernhardt Design will exercise its best judgement in selecting a carrier. Orders in production will be shipped as scheduled and cannot be held.

High quality cartoning meeting trucking and railroad specifications is standard at no extra charge. Some items may be blanket wrapped for shipment.

**Freight Damage and Claims**

Bernhardt Design is not liable for damages that occur during transit or storage. The carrier assumes all responsibility upon acceptance of product. It is the customer's responsibility to inspect all products upon receipt and file any claims with the carrier. No product should be refused.

If products are received damaged, a written exception should be made on the bill of lading and an immediate inspection be requested of the carrier. Concealed damage must be reported to the carrier within 10

business days from date of delivery. Failure to make claims shall constitute acceptance of the products and waiver any claims of defects, errors or shortages.

In the event delivery is made on a Bernhardt Design truck, the products should be carefully inspected for transit damage. If contents are damaged, the driver should be notified to call his dispatcher for immediate disposition. Concealed damage must be reported within 10 business days from date of delivery and product/packaging held for inspection by a Bernhardt Design representative.

Replacements for product damaged in shipment or storage will be manufactured upon receipt of a purchase order.

**Returns**

No merchandise may be returned to Bernhardt Design without written consent in the form of a Return Authorization from our Quality Assurance Department stating why the item is being returned and how the item will be shipped.

Unauthorized returns will be automatically refused by our receiving department as well as returns not in accordance with Bernhardt Design shipping instructions. Liability for defective merchandise shall be limited to the replacement or repair of that merchandise, and Bernhardt Design shall not be liable for other damages or losses.

**Measurements and Weights**

All measurements and weights are approximate and subject to change without notice.

**Care and Cleaning**

Finished wood surfaces should be cleaned with a soft damp cloth, wiping in the direction of the grain. Furniture should be buffed dry immediately with a soft cloth.

**Wood Finishes**

Bernhardt Design tables are available in finishes that are compatible with casegoods and seating finishes. However, finishes on tables may vary slightly from those on casegoods and seating due to the natural characteristics of the wood. No absolute match is implied or guaranteed.

**Light Finishes**

Bernhardt Design offers lighter finishes 836, 837, 840, 850, and 870 on certain veneers. Light finishes do not hide or mask the natural characteristics of the wood. Therefore, inherent natural characteristics of the wood will vary from piece to piece when using a light finish. Natural characteristics include the natural discolorations of the wood substance and color variations in glued up stock. These natural characteristics are not considered defects by Bernhardt Design, and therefore merchandise will not be replaced.

**Special Finishes**

Special finishes, made to customer specifications and subject to factory approval, may be available at a **5% net upcharge with a \$500 net minimum**.

Additional leadtime may be required for special finish items. Special finish orders will not be acknowledged until the special finish sample is approved in writing and received by Bernhardt Design Customer Service. Special finish orders are not subject to revision or cancellation after acknowledgment.

#### **Installation and Maintenance**

All freestanding casegoods are equipped with leveling devices. Local floor conditions vary, and it is always necessary to properly adjust leveling devices. Proper leveling is essential to the alignment and function of doors and drawers. Improperly leveled units result in misaligned doors and drawers and may impair locking mechanisms or other functional hardware.

After the initial installation of casegoods, it may be necessary to readjust and align the units to compensate for settling. This should be expected as a matter of routine maintenance and follow-up to assure proper case function.

Proper installation of Bernhardt Design casegoods is the responsibility of the dealer. Improperly installed units can result in permanent damage to case components. Damage due to improperly installed furniture not covered under product warranty.

#### **Warranty**

Bernhardt Design will repair or replace, at its discretion, any casegoods product or part thereof which fails as the result of defects in material and workmanship, under single shift use and normal care for five years. This warranty shall apply only to the original purchaser. This warranty does not cover normal wear and tear, misuse or abuse of product, dramatic temperature changes, exposure to unusual conditions or damages incurred by contact with seating products, tables, desks or other surfaces.

Natural color changes, variations or movements in lumber or veneer products, exposure to extreme temperature changes and direct sunlight may cause color changes and/or surface damage. These are circumstances beyond the control of Bernhardt Design and are not warranty issues. Repair or replacement of discontinued product will be at the discretion of Bernhardt Design.

This warranty is the customer's exclusive remedy for product defect and does not apply to damage caused by a freight carrier, dealer, installer, user modification, attachments to a product, or any third party. Bernhardt Design has the exclusive right to make the final determination of product misuse or abuse.

Except as stated above, Bernhardt Design makes no express or implied warranties as to any product, and in particular, makes no warranty of merchantability or of fitness for any particular purpose. Bernhardt Design shall not be liable for any consequential or incidental damages or for commercial loss arising from any product defect.

#### **Operational Parts Warranty**

Drawer glides, drawer boxes, drawer pulls, and lock mechanisms have a Life-Time Warranty for original purchaser. Power and communication components are warranted for one year.

#### **Wall Mount Units Warranty**

Wall mounted units are supplied with an adequate attachment device but not with hardware to attach this device to the support wall. It is the responsibility of the dealer/installer to ensure the wall structure is adequate to support the unit and that the attachment device is properly secured to the wall structure.

#### **Design and Patent Rights**

All of the products shown in Bernhardt Design catalogs and described in Bernhardt Design price lists are, and remain, the property of Bernhardt Design, with the sole right reserved to manufacture and to distribute.

Some of the product designs shown are patented in the United States and will remain the property of Bernhardt Design. Any reproduction of the products constitutes an infringement of patented copyright laws and will be subject to prosecution.

Bernhardt Design reserves the right to make changes in dimensions, design and/or construction, price lists, or product literature without prior notice.

#### **General Services Administration**

Products available on the Bernhardt Design GSA - Federal Supply Service Contract GS-27F-010GA are noted in the overview section of the product descriptions.

For information regarding GSA pricing, please contact your local Bernhardt Design sales representative or call 828.759.6337.

Send all GSA payments to:  
12197 Collections Center Drive  
Chicago IL 60693