

network credenzas

february 2019 price list

| | |
|--------------------------------------------|-------|
| index | 2 |
| collection overview | 3 |
| materials/finishes | 4 |
| storage credenzas assemblies 22''d | 5 |
| storage credenzas 22''d | 6 |
| tops - glass/solid surface 22''d | 7 |
| av/refrigerator credenzas assemblies 25''d | 8 |
| av/refrigerator credenzas 25''d | 9 |
| tops - glass/solid surface 25''d | 10 |
| av rotating/slideout equipment rack | 11 |
| guaranteed freight | 12 |
| terms and conditions | 13-14 |

Network Credenzas

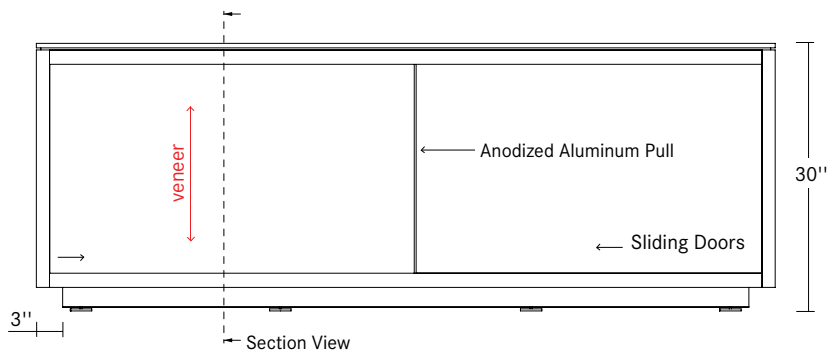

Front View/Standard Height

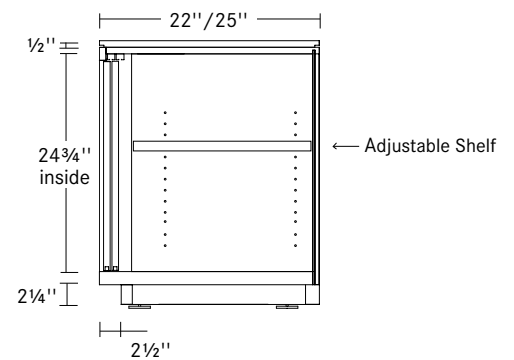

Section View/Standard Height

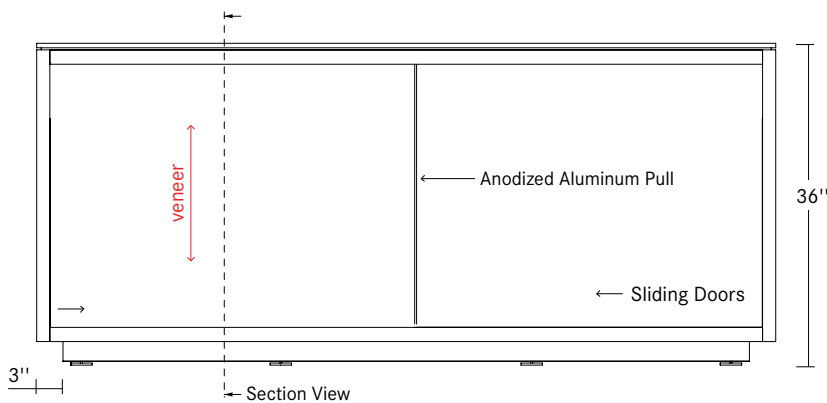

Front View/Serving Height

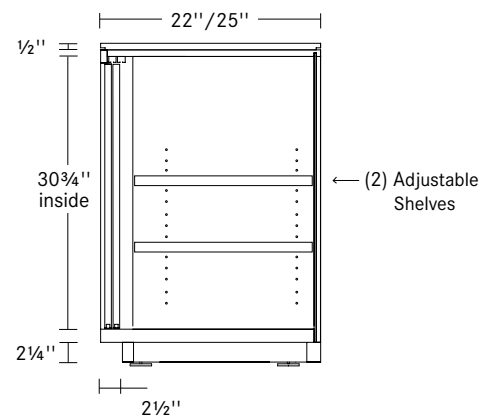

Section View/Serving Height

AV/Refrigerator Credenza

The Network av/refrigerator credenzas are designed to accommodate refrigeration needs and audiovisual equipment use and storage. Each av/refrigerator credenza comes standard with a vented, thermal sensor cooling fan installed. AV rotating/slideout equipment racks are available for installation, allowing for more flexibility and usage of space. **Refrigerators are not available for purchase from Bernhardt Design and must be purchased separately.**

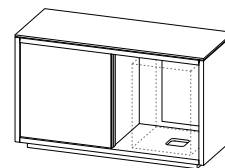

Front View
AV/Refrigerator Credenza

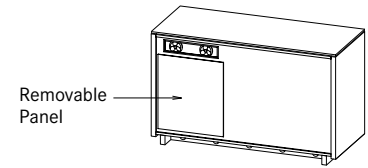

Back View
Showing Removeable Back Panel

AV Rotating/Slideout Equipment Rack

Rack max weight capacity: 200 lbs.
 Rail System: 19" overall depth, 38" extended
 AV rack must be screwed to the bottom of the case when installed.

Standard Height:
 12 usable rack spaces
 Usable Depth: 15 1/2"
 Usable Width: 18 1/2"

Serving Height:
 14 usable rack spaces
 Usable Depth: 15 1/2"
 Usable Width: 18 1/2"

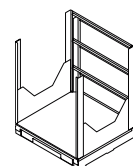

Front View
AV Rotating/Slideout Equipment Rack

Veneers

Veneer Selections



FL 1/2" Flat Edge

A three character sku identifies each species as well as the standard finish offered. Individual components are priced with standard finish. Special finishes on veneers made to customer specifications are subject to factory approval and a 5% net upcharge with a \$500 net minimum.

Transparent stains and sealers are applied in multiple steps to enhance the beauty of the natural wood. A durable, baked-on, top-coat of conversion varnish or UV topcoat is applied to protect the product. It is recommended that felt, cork or fabric backed desk pads and accessories are used on tops to minimize wear.

When specifying light finishes such as 836, 837, 840, 850 or 870, the color and characteristic variances of both veneer and solid wood are apparent. Therefore, exact color matches are not possible.

Tops/Credenzas

CHY Cherry

MPL Maple

WLT Walnut

OAK Oak

Flat Cut

Rift

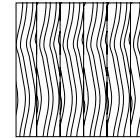
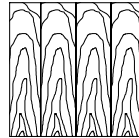

Standard Finishes

| CHY Cherry | MPL Maple | WLT Walnut | OAK Oak |
|------------|-----------|------------|---------|
| 805 | 837 | 823 | 805 865 |
| 834 | 850 | 839 | 836 866 |
| 836 | | 841 | 837 870 |
| 839 | | 860 | 839 |
| 840 | | 861 | 840 |
| 841 | | 866 | 860 |
| 861 | | 870 | 861 |

Glass Selections - Tops



PL 1/2" Polished Flat Edge

GPW Back-Painted White Glass - Top

GEW Etched, Back-Painted White Glass - Top

Solid Surface Selections - Tops

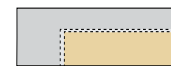

FL 1/4" Flat Edge

SSF Solid Surface

Standard Finish

CGW Corian, Glacier White

Pull/Hardware Selections

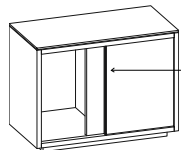

Aluminum Pull

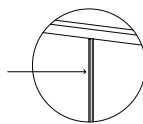

ST Tab

Ordering Guide/Product Selection Sequence

1. Select credenza depth
2. Select credenza type: assembly or credenza
3. Select standard or serving height
4. Select top material if credenza is specified
5. Select any required accessories

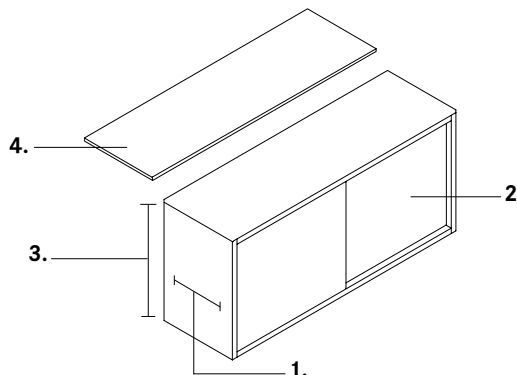

**storage credenzas
assemblies 22''d**



storage credenzas assemblies 22''d

includes 22''d, 1/2''h veneer top

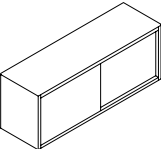
| description | sku | w | d | h | specifications | CHY |
|----------------------------------------------------------------------------------------------------------------------------------------------------------------------------------------------------|-----|-----|----|----|----------------|---------|
| | | | | | | cherry |
|  <p>standard height credenza</p> <p>2 sliding doors 1 polished aluminum pull 1 adjustable shelf</p> | CLA | 48 | 22 | 30 | no locks | \$ 5332 |
| | CLB | 54 | 22 | 30 | no locks | 5680 |
| | CLC | 60 | 22 | 30 | no locks | 5896 |
| | CLD | 66 | 22 | 30 | no locks | 6109 |
| | CLE | 72 | 22 | 30 | no locks | 6523 |
| | CLF | 78 | 22 | 30 | no locks | 6740 |
| | CLG | 84 | 22 | 30 | no locks | 7310 |
| | CLH | 90 | 22 | 30 | no locks | 7547 |
| | CLI | 96 | 22 | 30 | no locks | 7780 |
| | CLJ | 102 | 22 | 30 | no locks | 8275 |
| | CLK | 108 | 22 | 30 | no locks | 8508 |

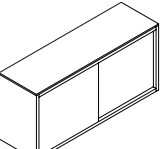
| description | sku | w | d | h | specifications | CHY |
|-----------------------------------------------------------------------------------------------------------------------------------------------------------------------------------------------------|-----|-----|----|----|----------------|--------|
| | | | | | | cherry |
|  <p>serving height credenza</p> <p>2 sliding doors 1 polished aluminum pull 1 adjustable shelf</p> | CHA | 48 | 22 | 36 | no locks | 5527 |
| | CHB | 54 | 22 | 36 | no locks | 5886 |
| | CHC | 60 | 22 | 36 | no locks | 6118 |
| | CHD | 66 | 22 | 36 | no locks | 6349 |
| | CHE | 72 | 22 | 36 | no locks | 6772 |
| | CHF | 78 | 22 | 36 | no locks | 7001 |
| | CHG | 84 | 22 | 36 | no locks | 7603 |
| | CHH | 90 | 22 | 36 | no locks | 7852 |
| | CHI | 96 | 22 | 36 | no locks | 8098 |
| | CHJ | 102 | 22 | 36 | no locks | 8608 |
| | CHK | 108 | 22 | 36 | no locks | 8857 |

specification codes example: CSS-SKU-FL

| series | sku | edge |
|---------------|-----|---------------|
| network | | FL 1/4'' flat |
| C S S - | - | F L |

material/finish code example: WLT 839

| material | finish |
|------------|------------|
| CHY cherry | see page 4 |
| MPL maple | |
| OAK oak | |
| WLT walnut | |
| | |

storage credenzas 22"d



storage credenzas 22"d

for use with 22"d glass, solid surface or com tops
specify top separately

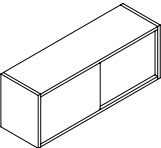
| description | sku | w | d | h | specifications | CHY | cherry |
|-------------------------------------------------------------------------------------------------------------------------------------------------------------------------------------------------|-----|-----|----|----|----------------|-----|---------|
| | | | | | | MPL | maple |
|  <p>standard height credenza 2 sliding doors 1 polished aluminum pull 1 adjustable shelf</p> | HLA | 48 | 22 | 30 | no locks | | \$ 4896 |
| | HLB | 54 | 22 | 30 | no locks | | 5220 |
| | HLC | 60 | 22 | 30 | no locks | | 5412 |
| | HLD | 66 | 22 | 30 | no locks | | 5603 |
| | HLE | 72 | 22 | 30 | no locks | | 5991 |
| | HLF | 78 | 22 | 30 | no locks | | 6182 |
| | HLG | 84 | 22 | 30 | no locks | | 6724 |
| | HLH | 90 | 22 | 30 | no locks | | 6933 |
| | HLI | 96 | 22 | 30 | no locks | | 7167 |
| | HLJ | 102 | 22 | 30 | no locks | | 7617 |
| | HLK | 108 | 22 | 30 | no locks | | 7824 |

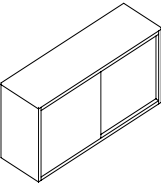
| description | sku | w | d | h | specifications | CHY | cherry |
|----------------------------------------------------------------------------------------------------------------------------------------------------------------------------------------------------|-----|-----|----|----|----------------|-----|--------|
| | | | | | | MPL | maple |
|  <p>serving height credenza 2 sliding doors 1 polished aluminum pull 2 adjustable shelves</p> | HHA | 48 | 22 | 36 | no locks | | 5087 |
| | HHB | 54 | 22 | 36 | no locks | | 5425 |
| | HHC | 60 | 22 | 36 | no locks | | 5631 |
| | HHD | 66 | 22 | 36 | no locks | | 5835 |
| | HHE | 72 | 22 | 36 | no locks | | 6281 |
| | HHF | 78 | 22 | 36 | no locks | | 6441 |
| | HHG | 84 | 22 | 36 | no locks | | 7015 |
| | HHH | 90 | 22 | 36 | no locks | | 7234 |
| | HHI | 96 | 22 | 36 | no locks | | 7458 |
| | HHJ | 102 | 22 | 36 | no locks | | 7944 |
| | HHK | 108 | 22 | 36 | no locks | | 8168 |

specification codes example: CSS-SKU-00

| series | sku | edge |
|---------------|-----|---------|
| network | | 00 none |
| C S S - | - | 0 0 |

material/finish code example: WLT 839

| material | finish |
|------------|------------|
| CHY cherry | see page 4 |
| MPL maple | |
| OAK oak | |
| WLT walnut | |
| | |

tops - glass/solid surface 22''d

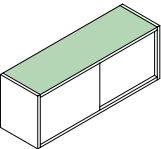

tops - glass/solid surface 22''d

| description | sku | w | d | h | GPW | GEW etched |
|---------------------------------------------------------------------------------------------------------------------------------------------------------------------------------------------------------------------------------------------------------|-----|-----|----|-----|-----------------------------|-----------------------------|
| | | | | | back-painted white glass | back-painted white glass |
|  <p>glass top 22''d 1/2'' glass top has veneer edge band subtop construction specify material code GPW or GEW specify subtop code and subtop finish code</p> | GLA | 48 | 22 | 1/2 | \$ 2025 | \$ 2471 |
| | GLB | 54 | 22 | 1/2 | 2205 | 2691 |
| | GLC | 60 | 22 | 1/2 | 2357 | 2876 |
| | GLD | 66 | 22 | 1/2 | 2537 | 3096 |
| | GLE | 72 | 22 | 1/2 | 2713 | 3310 |
| | GLF | 78 | 22 | 1/2 | 2893 | 3530 |
| | GLG | 84 | 22 | 1/2 | 3123 | 3811 |
| | GLH | 90 | 22 | 1/2 | 3275 | 3996 |
| | GLI | 96 | 22 | 1/2 | 3455 | 4216 |
| | GLJ | 102 | 22 | 1/2 | 3628 | 4427 |
| | GLK | 108 | 22 | 1/2 | 3779 | 4611 |

specification codes example: AKS-SKU-PL

| series | sku | edge |
|---------------|-----|------------------------|
| network | | PL 1/4'' polished flat |
| C S S - | - | P L |

material/finish code example: GPW CHT 805

| material | subtop | subtop finish |
|---------------------------------------------------------------------|-------------------------------------------------|---------------|
| GPW glass back-painted white GEW glass etched back-painted white | PNT paint CHY cherry MPL maple OAK oak | see page 4 |
| | | |

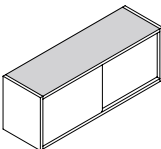
| description | sku | w | d | h | SSF solid surface* |
|---------------------------------------------------------------------------------------------------------------------------------------------------------|-----|-----|----|-------|--------------------|
| | | | | | |
|  <p>solid surface top 22''d 1 1/4''h solid surface top</p> | SFA | 48 | 22 | 1 1/4 | \$ 1710 |
| | SFB | 54 | 22 | 1 1/4 | 1868 |
| | SFC | 60 | 22 | 1 1/4 | 2020 |
| | SFD | 66 | 22 | 1 1/4 | 2171 |
| | SFE | 72 | 22 | 1 1/4 | 2323 |
| | SFF | 78 | 22 | 1 1/4 | 2488 |
| | SFG | 84 | 22 | 1 1/4 | 2661 |
| | SFH | 90 | 22 | 1 1/4 | 2813 |
| | SFI | 96 | 22 | 1 1/4 | 2993 |
| | SFJ | 102 | 22 | 1 1/4 | 3196 |
| | SFK | 108 | 22 | 1 1/4 | 3348 |

specification codes example: CSS-SKU-FL

| series | sku | edge |
|---------------|-----|---------------|
| network | | FL 1/4'' flat |
| C S S - | - | F L |

material/finish code example: SSF CGW

| material | finish |
|-------------------|-------------------|
| SSF solid surface | CGW glacier white |
| S S F | C G W |

av/refrigerator credenzas assemblies 25''d



av/refrigerator credenzas assemblies 25''d

includes 25''d, 1¼'' veneer top

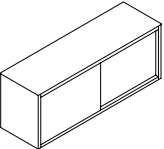
| description | sku | w | d | h | specifications | CHY |
|---------------------------------------------------------------------------------------------------------------------------------------------------------------------------------------------------------------------------------------------------------------------|-----|-----|----|----|----------------|---------|
| | | | | | | cherry |
|  <p>standard height av/refrigerator credenza</p> <p>2 sliding doors 1 polished aluminum pull 1 adjustable shelf removable back panel for av/refrigerator</p> | ALA | 48 | 25 | 30 | 1 lock | \$ 6317 |
| | ALB | 54 | 25 | 30 | 1 lock | 6657 |
| | ALC | 60 | 25 | 30 | 1 lock | 6871 |
| | ALD | 66 | 25 | 30 | 1 lock | 7080 |
| | ALE | 72 | 25 | 30 | 1 lock | 7488 |
| | ALF | 78 | 25 | 30 | 1 lock | 7701 |
| | ALG | 84 | 25 | 30 | 1 lock | 8315 |
| | ALH | 90 | 25 | 30 | 1 lock | 8547 |
| | ALI | 96 | 25 | 30 | 1 lock | 8782 |
| | ALJ | 102 | 25 | 30 | 1 lock | 9274 |
| | ALK | 108 | 25 | 30 | 1 lock | 9506 |

MPL maple
OAK oak
WLT walnut

Refrigerators are not available for purchase from Bernhardt Design and must be purchased separately

holds 1.5 cubic foot refrigerator
interior Dimensions: 28½''w x 20½''d x 24¾''h
specify separately the ACS-VCZ equipment rack

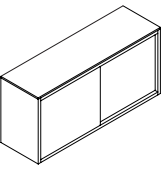
| | | | | | | |
|------------------------------------------------------------------------------------------------------------------------------------------------------------------------------------------------------------------------------------------------------------------------|-----|-----|----|----|--------|------|
|  <p>serving height av/refrigerator credenza</p> <p>2 sliding doors 1 polished aluminum pull 2 adjustable shelves removable back panel for av/refrigerator</p> | AHA | 48 | 25 | 36 | 1 lock | 6524 |
| | AHB | 54 | 25 | 36 | 1 lock | 6881 |
| | AHC | 60 | 25 | 36 | 1 lock | 7106 |
| | AHD | 66 | 25 | 36 | 1 lock | 7330 |
| | AHE | 72 | 25 | 36 | 1 lock | 7752 |
| | AHF | 78 | 25 | 36 | 1 lock | 7978 |
| | AHG | 84 | 25 | 36 | 1 lock | 8629 |
| | AHH | 90 | 25 | 36 | 1 lock | 8873 |
| | AHI | 96 | 25 | 36 | 1 lock | 9120 |
| | AHJ | 102 | 25 | 36 | 1 lock | 9626 |
| | AHK | 108 | 25 | 36 | 1 lock | 9874 |

Refrigerators are not available for purchase from Bernhardt Design and must be purchased separately

holds 1.7 cubic foot refrigerator
interior Dimensions: 28½''w x 20½''d x 30¾''h
specify separately the ACS-VCY equipment rack

specification codes example: CSS-SKU-FL

| series | sku | edge |
|---------------|-----|--------------|
| network | | FL 1¼'' flat |
| C S S - | - | F L |

material/finish code example: WLT 839

| material | finish |
|--------------------------------------------------|------------|
| CHY cherry MPL maple OAK oak WLT walnut | see page 4 |
| | |

av/refrigerator credenzas 25"d



av/refrigerator credenzas 25"d

for use with 25"d glass, solid surface or com tops
specify top separately

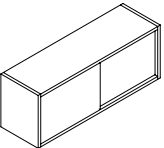
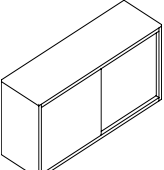
| description | sku | w | d | h | specifications | CHY | MPL | OAK | WLT |
|------------------------------------------------------------------------------------------------------------------------------------------------------------------------------------------------------------------------------------------------------------------------|------------------------------------------------------------------------------------------------------------------------------------------------------------------------------------------------------------------------------------------------------|-----|----|----|----------------|--------|-------|-----|--------|
| | | | | | | cherry | maple | oak | walnut |
|  <p>standard height av/refrigerator credenza</p> <p>2 sliding doors 1 polished aluminum pull 1 adjustable shelf removable back panel for av/refrigerator</p> | KLA | 48 | 25 | 30 | 1 lock | | | | 5869 |
| | KLB | 54 | 25 | 30 | 1 lock | | | | 6183 |
| | KLC | 60 | 25 | 30 | 1 lock | | | | 6369 |
| | KLD | 66 | 25 | 30 | 1 lock | | | | 6554 |
| | KLE | 72 | 25 | 30 | 1 lock | | | | 6938 |
| | KLF | 78 | 25 | 30 | 1 lock | | | | 7121 |
| | KLG | 84 | 25 | 30 | 1 lock | | | | 7701 |
| | KLH | 90 | 25 | 30 | 1 lock | | | | 7906 |
| | KLI | 96 | 25 | 30 | 1 lock | | | | 8112 |
| | KLJ | 102 | 25 | 30 | 1 lock | | | | 8578 |
| | KLK | 108 | 25 | 30 | 1 lock | | | | 8786 |
| | <p>holds 1.5 cubic foot refrigerator interior Dimensions: 28½"w x 20½"d x 24¾"h specify separately the ACS-VCZ equipment rack</p> <p>Refrigerators are not available for purchase from Bernhardt Design and must be purchased separately</p> | | | | | | | | |
|  <p>serving height av/refrigerator credenza</p> <p>2 sliding doors 1 polished aluminum pull 2 adjustable shelves removable back panel for av/refrigerator</p> | KHA | 48 | 25 | 36 | 1 lock | | | | 6072 |
| | KHB | 54 | 25 | 36 | 1 lock | | | | 6403 |
| | KHC | 60 | 25 | 36 | 1 lock | | | | 6604 |
| | KHD | 66 | 25 | 36 | 1 lock | | | | 6801 |
| | KHE | 72 | 25 | 36 | 1 lock | | | | 7196 |
| | KHF | 78 | 25 | 36 | 1 lock | | | | 7396 |
| | KHG | 84 | 25 | 36 | 1 lock | | | | 8009 |
| | KHH | 90 | 25 | 36 | 1 lock | | | | 8229 |
| | KHI | 96 | 25 | 36 | 1 lock | | | | 8449 |
| | KHJ | 102 | 25 | 36 | 1 lock | | | | 8930 |
| | KHK | 108 | 25 | 36 | 1 lock | | | | 9147 |
| | <p>holds 1.7 cubic foot refrigerator interior Dimensions: 28½"w x 20½"d x 30¾"h specify separately the ACS-VCY equipment rack</p> <p>Refrigerators are not available for purchase from Bernhardt Design and must be purchased separately</p> | | | | | | | | |

specification codes example: CSS-SKU-00

| series | sku | edge |
|---------------|-----|---------|
| network | | 00 none |
| C S S - | - | 0 0 |

material/finish code example: WLT 839

| material | finish |
|--------------------------------------------------|------------|
| CHY cherry MPL maple OAK oak WLT walnut | see page 4 |
| | |

tops - glass/solid surface 25''d



tops - glass/solid surface

for use with 25'' av/refrigerator credenzas

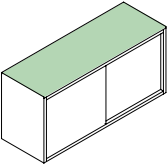
| description | sku | w | d | h | GPW | GEW etched |
|---------------------------------------------------------------------------------------------------------------------------------------------------------------------------------------------------------------------------------------------------------------|-----|----|----|-----|-----------------------------|-----------------------------|
| | | | | | back-painted white glass | back-painted white glass |
|  <p>glass top 25''d 1/2'' glass top has veneer edge band subtop constructio specify material code GPW or GEW specify subtop and subtop finish code</p> | GHA | 48 | 25 | 1/2 | \$ 2561 | \$ 3125 |
| | GHB | 54 | 25 | 1/2 | 2713 | 3310 |
| | GHC | 60 | 25 | 1/2 | 2893 | 3530 |
| | GHD | 66 | 25 | 1/2 | 3123 | 3811 |
| | GHE | 72 | 25 | 1/2 | 3275 | 3996 |
| | GHF | 78 | 25 | 1/2 | 3455 | 4216 |
| | GHG | 84 | 25 | 3/4 | 3628 | 4427 |
| | GHH | 90 | 25 | 3/4 | 3779 | 4611 |
| | GHI | 96 | 25 | 3/4 | 3979 | 4855 |

specification codes example: AKS-SKU-PL

| series | sku | edge |
|---------------|-----|------------------------|
| network | | PL 1/4'' polished flat |
| C S S - | - | P L |

material/finish code example: GPW CHT 805

| material | subtop | subtop finish |
|---------------------------------------------------------------------|-------------------------------------------------|---------------|
| GPW glass back-painted white GEW glass etched back-painted white | PNT paint CHY cherry MPL maple OAK oak | see page 4 |
| | | |

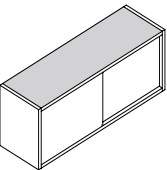
| description | sku | w | d | h | SSF solid |
|---------------------------------------------------------------------------------------------------------------------------------------------------------|-----|-----|----|-------|-----------|
| | | | | | surface* |
|  <p>solid surface top 25''d 1 1/4''h solid surface top</p> | SHA | 48 | 25 | 1 1/4 | \$ 1881 |
| | SHB | 54 | 25 | 1 1/4 | 2054 |
| | SHC | 60 | 25 | 1 1/4 | 2230 |
| | SHD | 66 | 25 | 1 1/4 | 2405 |
| | SHE | 72 | 25 | 1 1/4 | 2610 |
| | SHF | 78 | 25 | 1 1/4 | 2791 |
| | SHG | 84 | 25 | 1 1/4 | 2954 |
| | SHH | 90 | 25 | 1 1/4 | 3129 |
| | SHI | 96 | 25 | 1 1/4 | 3303 |
| | SHJ | 102 | 25 | 1 1/4 | 3476 |
| | SHK | 108 | 25 | 1 1/4 | 3652 |

specification codes example: CSS-SKU-FL

| series | sku | edge |
|---------------|-----|---------------|
| network | | FL 1/4'' flat |
| C S S - | - | F L |

material/finish code example: SSF CGW

| material | finish |
|-------------------|-------------------|
| SSF solid surface | CGW glacier white |
| S S F | C G W |

av rotating/slideout equipment rack

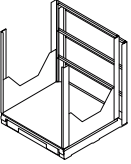
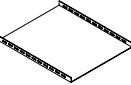
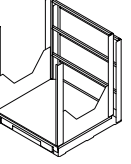
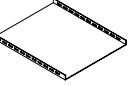

av rotating/slideout equipment rack

| description | sku | w | d | h | specifications | price |
|-------------------------------------------------------------------------------------------------------------------------------------------------------------------------------------------------------------------------------------------------------------------------------------------------------------------------------------------------------------|-----|-----|-------|-----|-----------------------|---------|
|  <p>standard height av rotating/slideout equipment rack</p> <p>use with 30" h av/refrigerator credenzas telescoping depth: 16" - 26" rack max weight capacity: 200 lb. field assembled and installed specify separately the ACS-VCX av shelf</p> | VCZ | 19 | 19-38 | 24 | 12 usable rack spaces | \$ 1965 |
|  <p>av shelf</p> <p>sliding rail system shelf, mounts to rack rails slots for securing components with straps hardware included usable depth: 15½" usable width: 18½" specify separately the ACS-VCZ equipment rack</p> | VCX | 19 | 16¼ | 1½ | | 549 |
|  <p>serving height av rotating/slideout equipment rack</p> <p>use with 30" h av/refrigerator credenzas telescoping depth: 16" - 26" max weight capacity: 200 lb. field assembled and installed specify separately the ACS-VCX av shelf</p> | VCY | 19 | 19-38 | 27½ | 14 usable rack spaces | 2081 |
|  <p>av shelf</p> <p>sliding rail system shelf, mounts to rack rails slots for securing components with straps hardware included usable depth: 15½" usable width: 18½" specify separately the ACS-VCY equipment rack</p> | VCW | 18¾ | 16¼ | 1½ | | 361 |

specification codes example: ACS-SKU

| series | sku |
|---------------|-----|
| accessory | |
| A C S - | |

Preferred Carrier Guaranteed Freight Rates

Freight charges will be applied to orders as a separate line item based on the zones listed. Rates are based on zones with a minimum for each zone. All zones are located within the Continental United States.

The freight amount is calculated on the total merchandise net price, excluding any extra discounts beyond standard net pricing. Additional freight fuel surcharges may apply. Rates are based on deliveries made Monday through Friday, 8 am until 5 pm.

All orders are shipped by Bernhardt Design company trucks or preferred carriers specified by Bernhardt Design. **If a purchase order does not specify that the product must ship complete, Bernhardt Design reserves the right to select the most effective shipping method necessary, including split shipments.** Dealer warehouse information, including phone number and contact name, must be specified on the purchase order.

Direct site deliveries may be requested with an additional freight cost. Requests for direct site deliveries must be made 2 weeks prior to the scheduled ship week and meet the following criteria:

- Minimum of half truckload
- Delivery site accessible by a 53' trailer
- Complete delivery site address with contact name and on-site phone number
- Labor available for unloading

Deliveries that do not meet the criteria must be directed to a receiver warehouse. If a receiver warehouse is not available, the dealer may make arrangements with their own 3rd party carrier. If a 3rd party carrier is elected, a contact name, phone number and e-mail address is required.

Weekend direct site deliveries will incur a \$500 per trailer weekend delivery fee. Weekend is defined as between 5 pm Friday and 8 am Monday.

| Zone | Minimum Charge | Freight Rate |
|------|----------------|--------------|
| 1 | \$80 | 5% |
| 2 | \$80 | 6% |
| 3 | \$90 | 7% |
| 4 | \$90 | 8% |
| 5 | \$90 | 9% |
| 6 | \$110 | 10% |
| 7 | \$110 | 11% |
| 8 | \$120 | 12% |
| 9 | \$120 | 13% |
| 10 | \$120 | 15% |

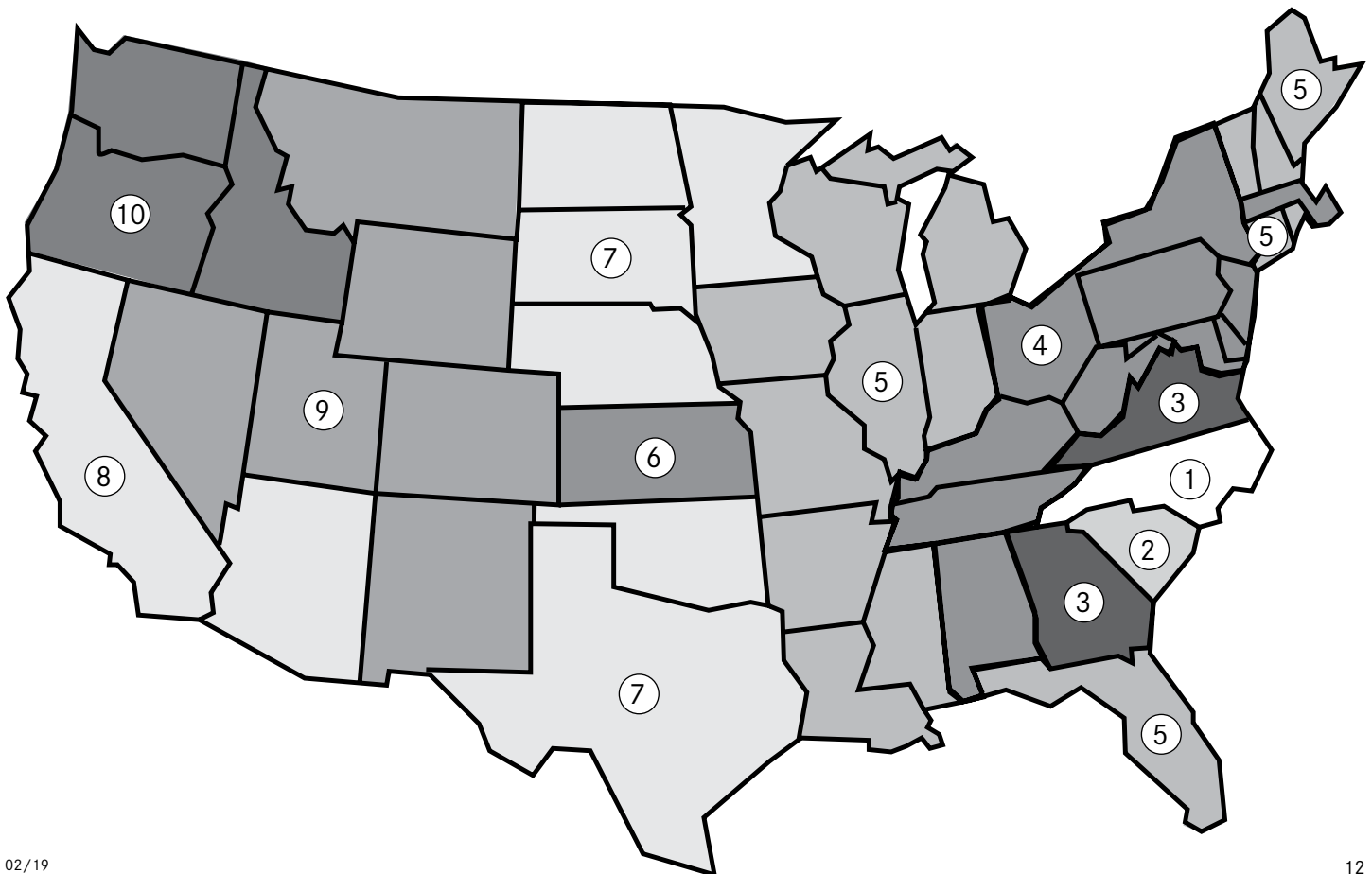

Sales and Service Policy

Guidelines detailing the operating policies and procedures of Bernhardt Design are provided in the Sales and Service Policy available online at <http://www.bernhardtdesign.com/sales-and-service-policy>.

Prices and Specifications

Prices and specifications are subject to change without notice. All prices quoted will be FOB our factories. If applicable, sales tax will be based on ship-to destination.

Bernhardt Design reserves the right to make changes in dimensions, construction, price lists, or product literature without prior notice.

Order Entry

All orders are subject to final acceptance by Bernhardt Design in Lenoir, NC. Receipt of our acknowledgment indicates acceptance of your order subject to the terms set forth on the acknowledgment. Bernhardt Design attempts to clarify all purchase orders. However, in the event the price list number and description on the purchase order differ, the price list number will prevail.

Changes / Cancellation

All orders in production are considered firm orders and are not subject to changes or cancellation.

Custom Design

Bernhardt Design may alter products to meet specific needs. Contact your local sales representative when a custom design is needed. Custom designs require minimum quantities, additional lead time, and upcharges.

A custom job number, available from your local sales representative, must be submitted with purchase orders. Orders combining custom design with standard product cannot be scheduled for production until custom items are approved. Custom design orders are not subject to revision or cancellation after acknowledgment.

Shipping

Bernhardt Design will ship in accordance with customer instructions whenever possible. If not specified, Bernhardt Design will exercise its best judgment in selecting a carrier. When selecting a carrier, Bernhardt Design will make our best effort to meet requested delivery dates. Transportation lead-times and delays including equipment problems, weather, general traffic, traffic accidents, customer warehouse space, labor disputes, customer changes etc., that occur on a carrier will not be the responsibility of Bernhardt Design. Furthermore, Bernhardt Design will not be responsible for additional costs incurred due to aforementioned delays.

Customer orders in production will be shipped as scheduled and will not be held. Bernhardt Design reserves the right to make partial shipments on any order, unless notified otherwise by the customer.

High quality cartoning meeting trucking and railroad specifications is standard at no extra charge. Some items may be blanket wrapped for shipment.

Freight Damage and Claims

Bernhardt Design is not liable for damages that occur during transit or storage. The carrier assumes all responsibility upon acceptance of product. It is the customer's responsibility to inspect all products upon receipt and file any claims with the carrier. No product should be refused.

If products are received damaged, a written exception should be made on the bill of lading and an immediate inspection be requested of the carrier. Concealed damage must be reported to the carrier within 10 business days from date of delivery. Failure to make claims shall constitute acceptance of the products and waiver any claims of defects, errors or shortages.

In the event delivery is made on a Bernhardt Design truck, the products should be carefully inspected for transit damage. If contents are damaged, the driver should be notified to call his dispatcher for immediate disposition. Concealed damage must be reported within 10 business days from date of delivery and product/packaging held for inspection by a Bernhardt Design representative.

Replacements for product damaged in shipment or storage will be manufactured upon receipt of a purchase order.

Returns

No merchandise may be returned to Bernhardt Design without written consent in the form of a Return Authorization from our Quality Assurance Department stating why the item is being returned and how the item will be shipped.

Unauthorized returns will be automatically refused by our receiving department as well as returns not in accordance with Bernhardt Design shipping instructions. Liability for defective merchandise shall be limited to the replacement or repair of that merchandise, and Bernhardt Design shall not be liable for other damages or losses.

Measurements and Weights

All measurements and weights are approximate and subject to change without notice.

Care and Cleaning

Finished wood surfaces should be cleaned with a soft damp cloth, wiping in the direction of the grain. Furniture should be buffed dry immediately with a soft cloth.

Wood Finishes

Bernhardt Design tables are available in finishes that are compatible with casegoods and seating finishes. However, finishes on tables may vary slightly from those on casegoods and seating due to the natural characteristics of the wood. No absolute match is implied or guaranteed.

Light Finishes

Bernhardt Design offers lighter finishes 836, 837, 840, 850, and 870 on certain veneers. Light finishes do not hide or mask the natural characteristics of the wood. Therefore, inherent natural characteristics of the wood will vary from piece to piece when using a light finish.

Natural characteristics include the natural discolorations of the wood substance and color variations in glued up stock. These natural characteristics are not considered defects by Bernhardt Design, and therefore merchandise will not be replaced.

Special Finishes

Special finishes, made to customer specifications and subject to factory approval, may be available at a **5% net upcharge with a \$500 net minimum**.

Additional leadtime may be required for special finish items. Special finish orders will not be acknowledged until the special finish sample is approved in writing and received by Bernhardt Design Customer Service. Special finish orders are not subject to revision or cancellation after acknowledgment.

Installation and Maintenance

All freestanding casegoods are equipped with leveling devices. Local floor conditions vary, and it is always necessary to properly adjust leveling devices. Proper leveling is essential to the alignment and function of doors and drawers. Improperly leveled units result in misaligned doors and drawers and may impair locking mechanisms or other functional hardware.

After the initial installation of casegoods, it may be necessary to readjust and align the units to compensate for settling. This should be expected as a matter of routine maintenance and follow-up to assure proper case function.

Proper installation of Bernhardt Design casegoods is the responsibility of the dealer. Improperly installed units can result in permanent damage to case components. Damage due to improperly installed furniture not covered under product warranty.

Warranty

Bernhardt Design will repair or replace, at its discretion, any casegoods product or part thereof which fails as the result of defects in material and workmanship, under single shift use and normal care for five years. This warranty shall apply only to the original purchaser. This warranty does not cover normal wear and tear, misuse or abuse of product, dramatic temperature changes, exposure to unusual conditions or damages incurred by contact with seating products, tables, desks or other surfaces.

Natural color changes, variations or movements in lumber or veneer products, exposure to extreme temperature changes and direct sunlight may cause color changes and/or surface damage. These are circumstances beyond the control of Bernhardt Design and are not warranty issues. Repair or replacement of discontinued product will be at the discretion of Bernhardt Design.

This warranty is the customer's exclusive remedy for product defect and does not apply to damage caused by a freight carrier, dealer, installer, user modification, attachments to a product, or any third party. Bernhardt Design has the exclusive right to make the final determination of product misuse or abuse.

Except as stated above, Bernhardt Design makes no express or implied warranties as to any product, and in particular, makes no warranty of merchantability or of fitness for any particular purpose. Bernhardt Design shall not be liable for any consequential or incidental damages or for commercial loss arising from any product defect.

Operational Parts Warranty

Drawer glides, drawer boxes, drawer pulls, and lock mechanisms have a Life-Time Warranty for original purchaser. Power and communication components are warranted for one year.

Wall Mount Units Warranty

Wall mounted units are supplied with an adequate attachment device but not with hardware to attach this device to the support wall. It is the responsibility of the dealer/installer to ensure the wall structure is adequate to support the unit and that the attachment device is properly secured to the wall structure.

Design and Patent Rights

All of the products shown in Bernhardt Design catalogs and described in Bernhardt Design price lists are, and remain, the property of Bernhardt Design, with the sole right reserved to manufacture and to distribute.

Some of the product designs shown are patented in the United States and will remain the property of Bernhardt Design. Any reproduction of the products constitutes an infringement of patented copyright laws and will be subject to prosecution.

Bernhardt Design reserves the right to make changes in dimensions, design and/or construction, price lists, or product literature without prior notice.

General Services Administration

Products available on the Bernhardt Design GSA - Federal Supply Service Contract GS-27F-010GA are noted in the overview section of the product descriptions.

For information regarding GSA pricing, please contact your local Bernhardt Design sales representative or call 828.759.6337.

Send all GSA payments to:
12197 Collections Center Drive
Chicago IL 60693