

Profile Installation Instructions

Profile credenzas will require installation by qualified personnel, following state and local regulations as determined by the installation location. **SAVE THESE INSTRUCTIONS.**

The Profile credenza is constructed and has been tested in conformance with BIFMA furniture standards.

Pillar installation will only be applicable to SKUs with pillars, go directly to step 4 if SKU does not include pillar.

Both Pillar and Credenza need to be attached to the wall.

Read the following instructions prior to installation of the Profile credenzas.

Profile credenza assembly will require the following tools:

- Cordless Drill
- 48" to 60" Level
- Tape Measure
- Drill Bits

Bernhardt design recommends the following hardware:

- Toggler® Snaptoggle® or similar high performance anchors - we suggest you use 1/4" - 20 bolt version for added flexibility.

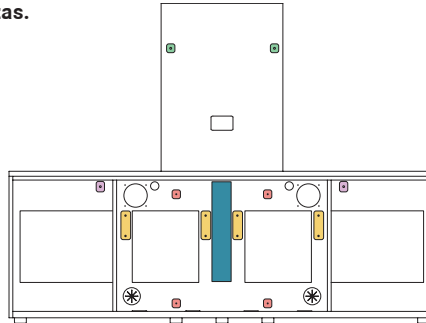

- AV rack mount holes
- Pillar Attachment
- Wire Management
- Anchor holes for pillar attachment
- Anchor holes for credenza attachment

Showing 63" short pillar and case without doors.

1

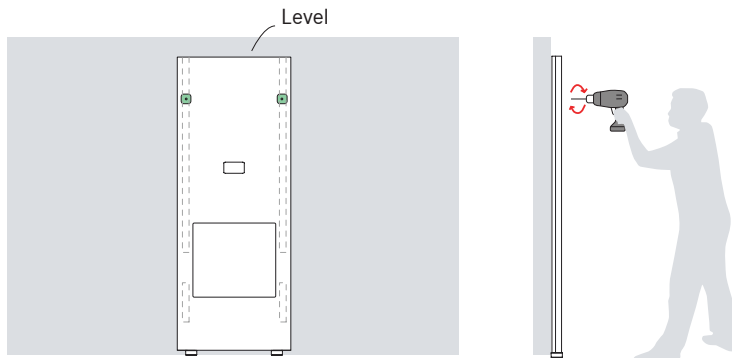

Showing 63" short pillar. Level pillar by adjusting levelers.

Place pillar against the wall.
Plumb and level pillar.

Mark holes for pillar attachment - highlighted in green.

Pre-drill holes into drywall for preferred anchor using a 1/4" drill bit.

2

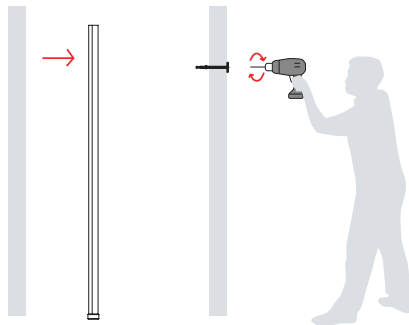

Once both holes have been drilled, remove and set aside pillar. Using a 1/2" drill bit, open up the (2) 1/4" holes just drilled into the drywall to 1/2".

Install (1) Toggler® Snaptoggle® wall anchor into each of the 1/2" holes.

3

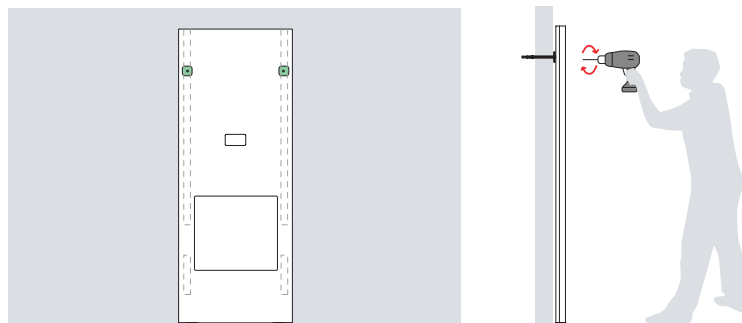

Replace pillar and fasten 1/4" - 20 bolts into each of the Toggler® Snaptoggle® wall anchors.
Be sure to level again before securing pillar.

Mount user supplied TV mount and run cabling.

Profile Installation Instructions

Profile credenzas will require installation by qualified personnel, following state and local regulations as determined by the installation location. **SAVE THESE INSTRUCTIONS.**

The Profile credenza is constructed and has been tested in conformance with BIFMA furniture standards.

Pillar installation will only be applicable to SKUs with pillars, go directly to step 4 if SKU does not include pillar.

Both Pillar and Credenza need to be attached to the wall.

Read the following instructions prior to installation of the Profile credenzas.

Profile credenza assembly will require the following tools:

- Cordless Drill
- 48" to 60" Level
- Tape Measure
- Drill Bits

Bernhardt design recommends the following hardware:

- Toggler® Snaptoggle® or similar high performance anchors
- we suggest you use 1/4" - 20 bolt version for added flexibility.

4

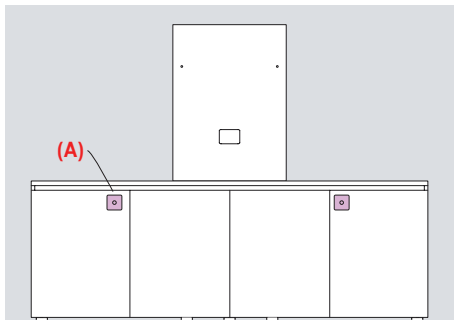

Showing 63" short pillar.

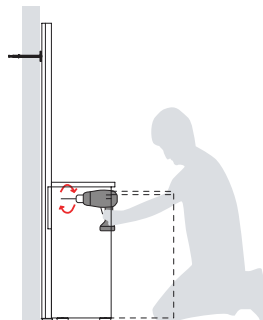

Place credenza against wall or pillar.
Plumb and level case.

Mark holes for credenza attachment to wall highlighted in purple.

(A) Pre-drill holes into drywall for preferred anchor using a 1/4" drill bit. Holes shown in purple.

5

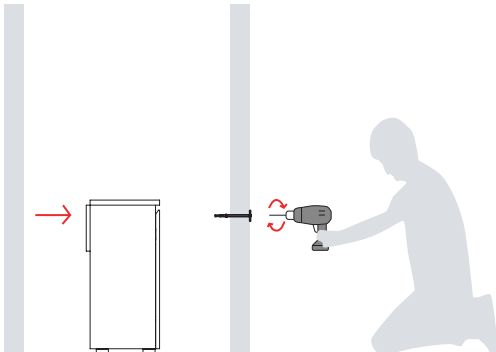

Once both holes have been drilled, remove and set aside credenza.

Using a 1/2" drill bit, open up the (2) 1/4" holes just drilled into the drywall to 1/2".

Install (1) Toggler® Snaptoggle® wall anchor into each of the 1/2" holes.

6

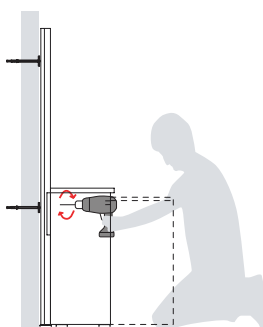
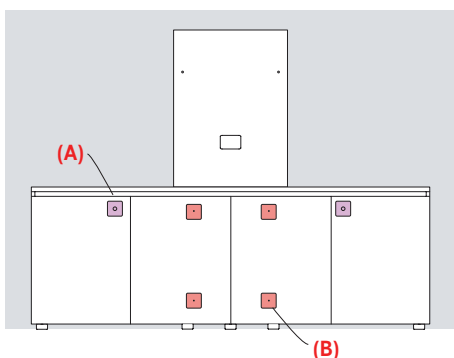

Install equipment and wire as needed.

Replace credenza and align with anchor holes.

(A) Fasten 1/4" - 20 bolts into each of the Toggler® Snaptoggle® wall anchors.
Be sure to level again before securing credenza.

(B) For SKU's with Pillar: Using provided #8 screws, attach pillar to case. Holes shown in red.
Be sure to level again before securing credenza.

Clear case free of any saw dust.